



TIMBERWOLF[®]
Lead the pack

TW 280TDHB WOOD CHIPPER



INSTRUCTION MANUAL

timberwolf-uk.com

© Copyright Entec Industries Ltd 2015

The content of this publication may not be copied, reproduced, republished, posted, broadcast, transmitted or used in any way in any medium without the written permission of Entec Industries Ltd.



<i>Section</i>	<i>Page No.</i>
INTRODUCTION	1
PURPOSE OF MACHINE	2
MACHINE DIMENSIONS & SPECIFICATIONS	2
PARTS LOCATION DIAGRAMS	3
SAFE WORKING	5
Operator's Personal Protective Equipment Required	5
Basic Woodchipping Safety	5
General Safety Matters - Do's and Dont's	6
Noise Test	7
OPERATING INSTRUCTIONS	8
Safe Transportation	8
Hitching onto the Tow Ball	8
Unhitching the Chipper	8
Stabilising the Chipper	8
Delivery	9
Operator's Personal Protective Equipment Required	9
Manual Controls	9
Auto Controls	10
Emergency Stopping	10
Daily Checks Before Starting	10
Discharge Controls	10
Before Using the Chipper	11
Engine Controls	11
Starting the Engine	11
Controlling the Engine Speed	11
Stopping the Engine	11
Blade Wear	12
Starting to Chip	12
Chipping	12
Blockages	13
Hydraulic Oil Level Indicator	13
Fuel Level Indicator	13
SERVICE INSTRUCTIONS	14
Service Schedule	15
Safe Maintenance	16
Safe Lifting of the Chipper	16
Spares	16
Battery Removal and Maintenance	16
Check Fittings	16
Copper Ease Safety Information	18
Battery Safety Information	17
Change Blades	19
Tension Drive Belts	20
Change Hydraulic Oil and Filter	20
Check Hoses	20
Grease the Roller Spline and Bearing	21
Grease the Roller Box Slides	21
Grease the Discharge Flange	21
Engine Servicing	21
WARRANTY STATEMENT	22
EC DECLARATION OF CONFORMITY CERTIFICATE	23
IDENTIFICATION PLATE	24
DECALS	25
ELECTRICAL PARTS LOCATOR	27
CIRCUIT DIAGRAM	28
HYDRAULIC LAYOUT	29
V- BELT TENSIONING TABLE	30
PARTS LISTS	32
WARRANTY SERVICE CHECK RECORD	56
SERVICE RECORD	57



INTRODUCTION

Thank you for choosing Timberwolf. Timberwolf chippers are designed to give safe and dependable service if operated according to the instructions.

IMPORTANT HEALTH AND SAFETY INFORMATION

Before using your new chipper, please take time to read this manual. Failure to do so could result in:

- PERSONAL INJURY
- EQUIPMENT DAMAGE
- DAMAGE TO PROPERTY
- 3RD PARTY INJURIES

This manual covers the operation and maintenance of the Timberwolf TW 280TDHB. All information in this manual is based on the latest product information available at the time of purchase.

All the information you need to operate the machine safely and effectively is contained within pages 2 to 13. Ensure that all operators are **properly trained** for operating this machine, especially **safe working practices**.

Timberwolf's policy of regularly reviewing and improving their products may involve major or minor changes to the chippers or their accessories. Timberwolf reserves the right to make changes at any time without notice and without incurring any obligation.

Due to improvements in design and performance during production there may be, in some cases, minor discrepancies between the actual chipper and the text in this manual.

The manual should be considered an important part of the machine and should remain with it if the machine is resold.

ALWAYS FOLLOW SAFE OPERATING AND MAINTENANCE PRACTICES



CAUTION or WARNING

BE AWARE OF THIS SYMBOL AND WHERE SHOWN, CAREFULLY FOLLOW THE INSTRUCTIONS.

This caution symbol indicates important safety messages in this manual. When you see this symbol, be alert to the possibility of injury to yourself or others and carefully read the message that follows.



The Timberwolf TW 280TDHB

Designed to chip solid wood material up to 200mm in diameter and capable of chipping up to 6.5 tonnes of brushwood per hour.

DIMENSIONS

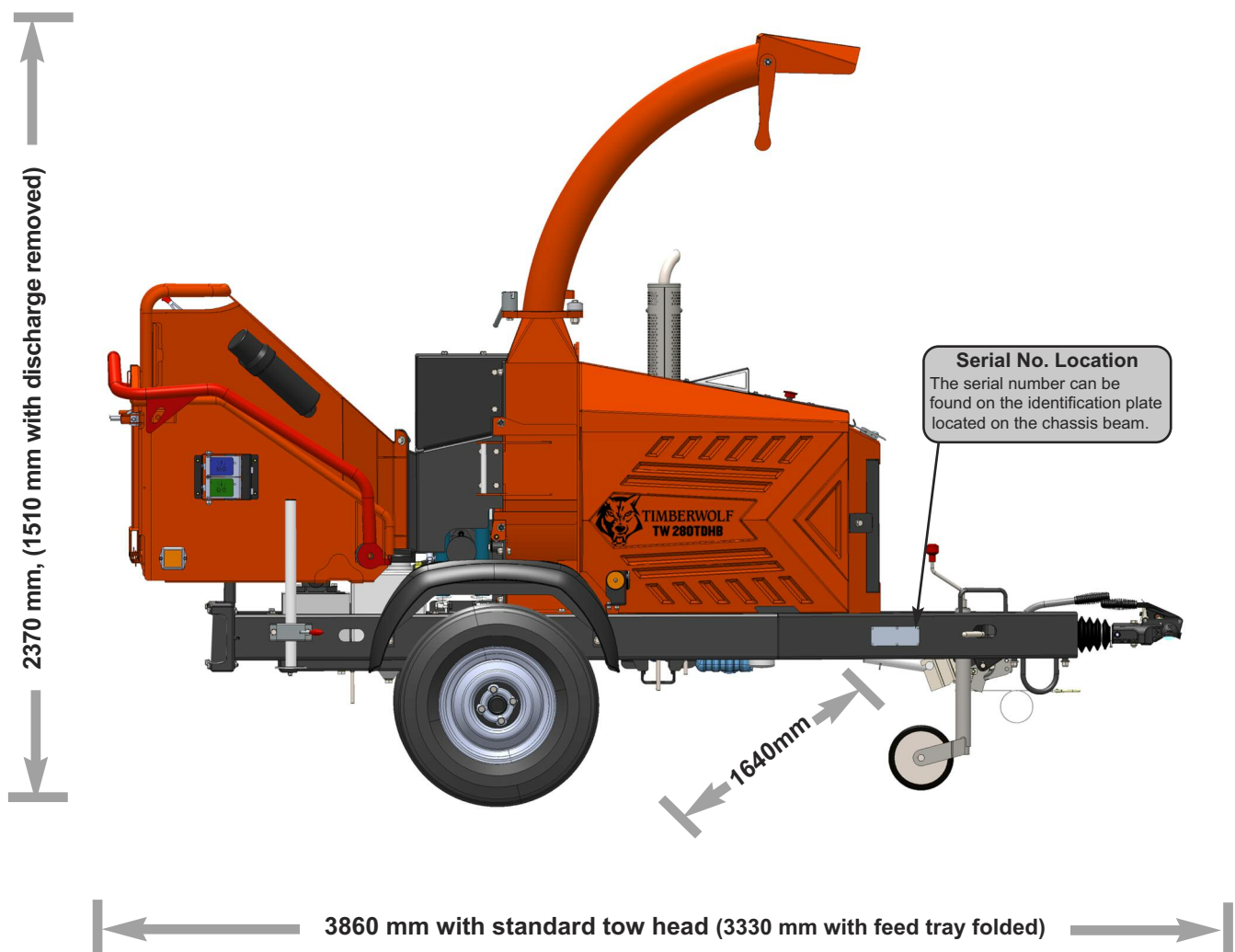

TIMBERWOLF TW 280TDHB (FIXED TOWHEAD) SPECIFICATION

Engine type	<i>Kubota 4-cylinder turbo diesel</i>	Maximum diameter material	210mm (8.26")
Maximum power	33kW (45hp)	Fuel capacity	36 litres
Cooling method	<i>Water cooled</i>	Hydraulic oil capacity	15 litres
Overall weight	1180kg	Material processing capacity	<i>up to 6.5 tonnes/hr</i>
Starting method	<i>Electric</i>	Fuel type	<i>Diesel</i>
Roller feed	<i>Twin series hydraulic motors</i>		



PARTS LOCATOR

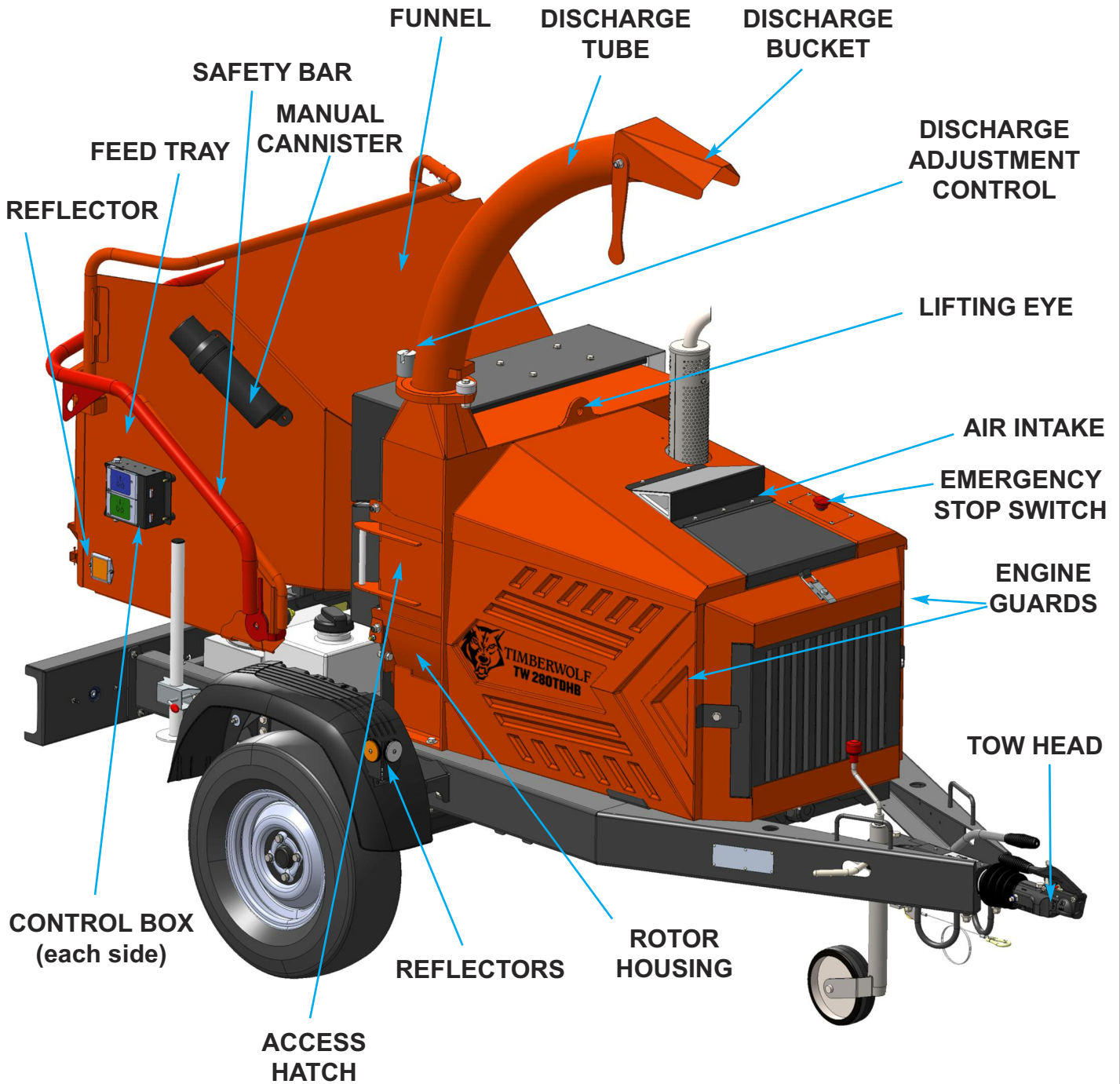



PARTS LOCATOR

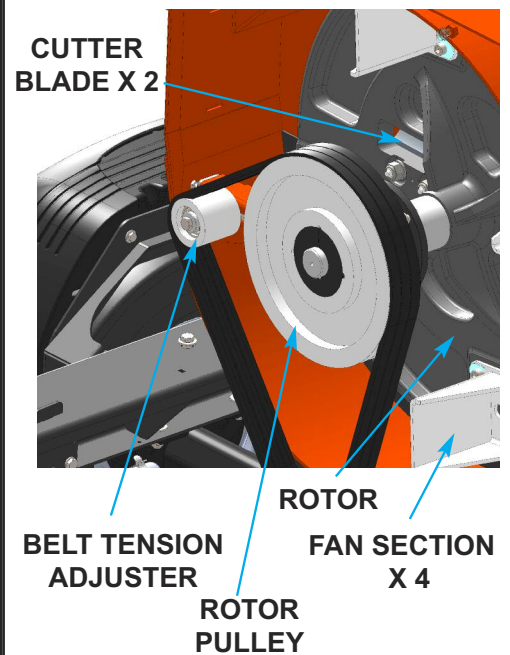
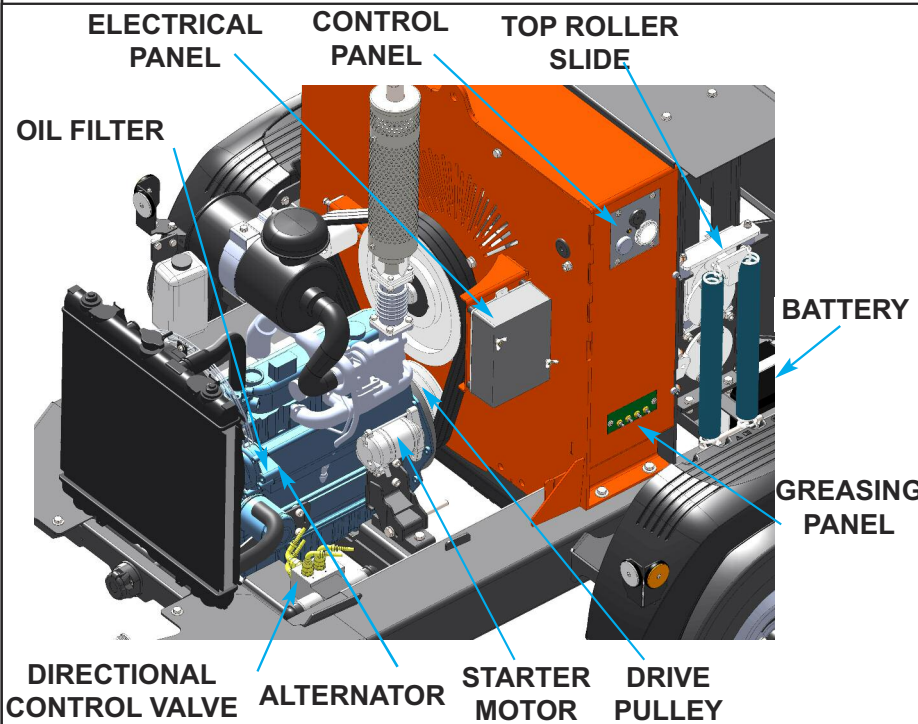
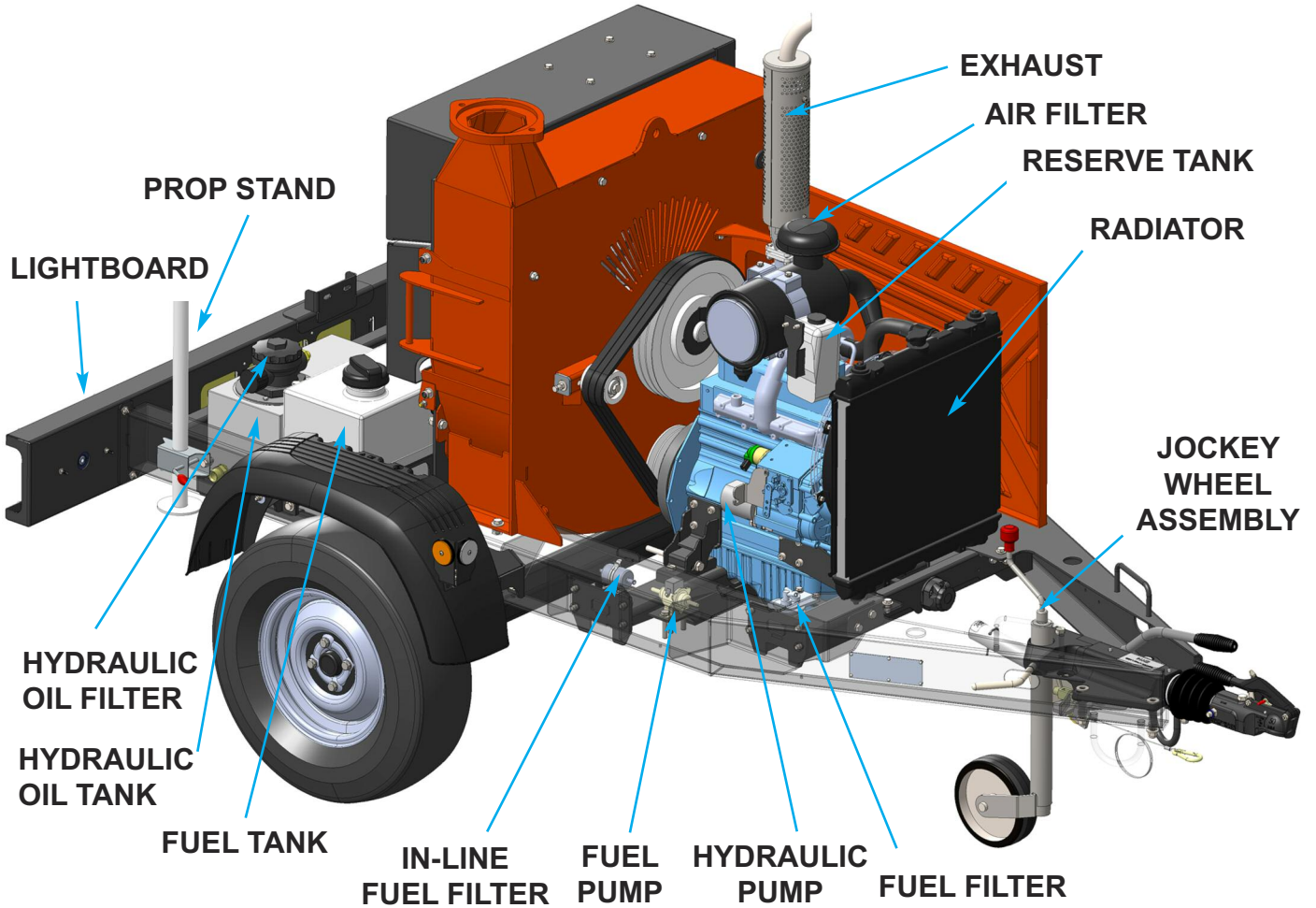



WARNING

The chipper will feed material through on its own. To do this, it relies on sharp blades both on the feed rollers and the chipper rotor. To keep the blades sharp, only feed the machine with clean brushwood. **DO NOT** put muddy/dirty wood, roots, potted plants, bricks, stones or metal into the chipper.



OPERATOR'S PERSONAL PROTECTIVE EQUIPMENT REQUIRED



Chainsaw safety helmet fitted with mesh visor and recommended ear defenders to the appropriate specifications.



Close fitting heavy-duty non-snag clothing.



Work gloves with elasticated wrist.



Face mask if appropriate.



Steel toe cap safety boots.



DO NOT wear rings, bracelets, watches, jewellery or any other items that could be caught in the material and draw you into the chipper.

BASIC WOODCHIPPING SAFETY

The operator should be aware of the following points:

- **MAINTAIN A SAFETY EXCLUSION ZONE** around the chipper of at least 10 metres for the general public or employees without adequate protection. Use hazard tape to identify this working area and keep it clear from debris build up. Chips should be ejected away from any area the general public have access to.
- **HAZARDOUS MATERIAL** - Some species of trees and bushes are poisonous. The chipping action can produce vapour, spray and dust that can irritate the skin. This may lead to respiratory problems or even cause serious poisoning. Check the material to be chipped before you start. Avoid confined spaces and use a facemask if necessary.
- **BE AWARE** when the chipper is processing material that is an awkward shape. The material can move from side to side in the funnel with great force. If the material extends beyond the funnel, the brush may push you to one side causing danger. Badly twisted brush should be trimmed before being chipped to avoid thrashing in the feed funnel.
- **BE AWARE** that the chipper can eject chips out of the feed funnel with considerable force. Always wear full head and face protection.
- **ALWAYS** work on the side of the machine furthest from any local danger, e.g. not road side.



GENERAL SAFETY MATTERS



DO'S AND DON'TS



ALWAYS stop the chipper engine before making any adjustments, refuelling or cleaning.

ALWAYS check rotor has stopped rotating and remove chipper ignition key before maintenance of any kind, or whenever the machine is to be left unattended.

ALWAYS check the machine is well supported and cannot move.

ALWAYS operate the chipper with the engine set to maximum speed when chipping.

ALWAYS check (visually) for fluid leaks.

ALWAYS take regular breaks. Wearing personal protective equipment for long periods can be tiring and hot.

ALWAYS keep hands, feet and clothing out of feed opening, discharge and moving parts.

ALWAYS use the next piece of material or a push stick to push in short pieces. Under no circumstances should you reach into the funnel.

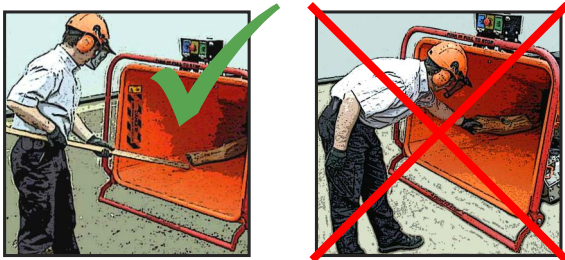

ALWAYS keep the operating area clear of people, animals and children.

ALWAYS keep the operating area clear from debris build up.

ALWAYS keep clear of the chip discharge tube. Foreign objects may be ejected with great force.

ALWAYS ensure protective guarding is in place before commencing work. Failure to do so may result in personal injury or loss of life.

ALWAYS operate the chipper in a well ventilated area - exhaust fumes are dangerous.

DO NOT operate chipper unless available light is sufficient to see clearly.

DO NOT use or attempt to start the chipper without the feed funnel, guards and discharge unit securely in place.

DO NOT stand directly in front of the feed funnel when using the chipper. Stand to one side.

DO NOT allow -



BRICKS STRING CLOTH PLASTIC STONES



METAL GLASS RUBBER ROOTS BEDDING PLANTS

- to enter the machine, as damage is likely.

DO NOT smoke when refuelling.



DO NOT let anyone who has not received instruction operate the machine.

DO NOT climb on the machine at any time.

DO NOT handle material that is partially engaged in the machine.

DO NOT touch any exposed wiring while machine is running.

DO NOT use the chipper inside buildings.



NOISE TEST

MACHINE: TW 280TDHB

NOTES: Tested chipping 200mm x 200mm corsican pine 1.5m in length

Noise levels above 80dB (A) will be experienced at the working position. Wear ear protection at all times to prevent possible damage to hearing. All persons within a 4 metre radius must also wear good quality ear protection.

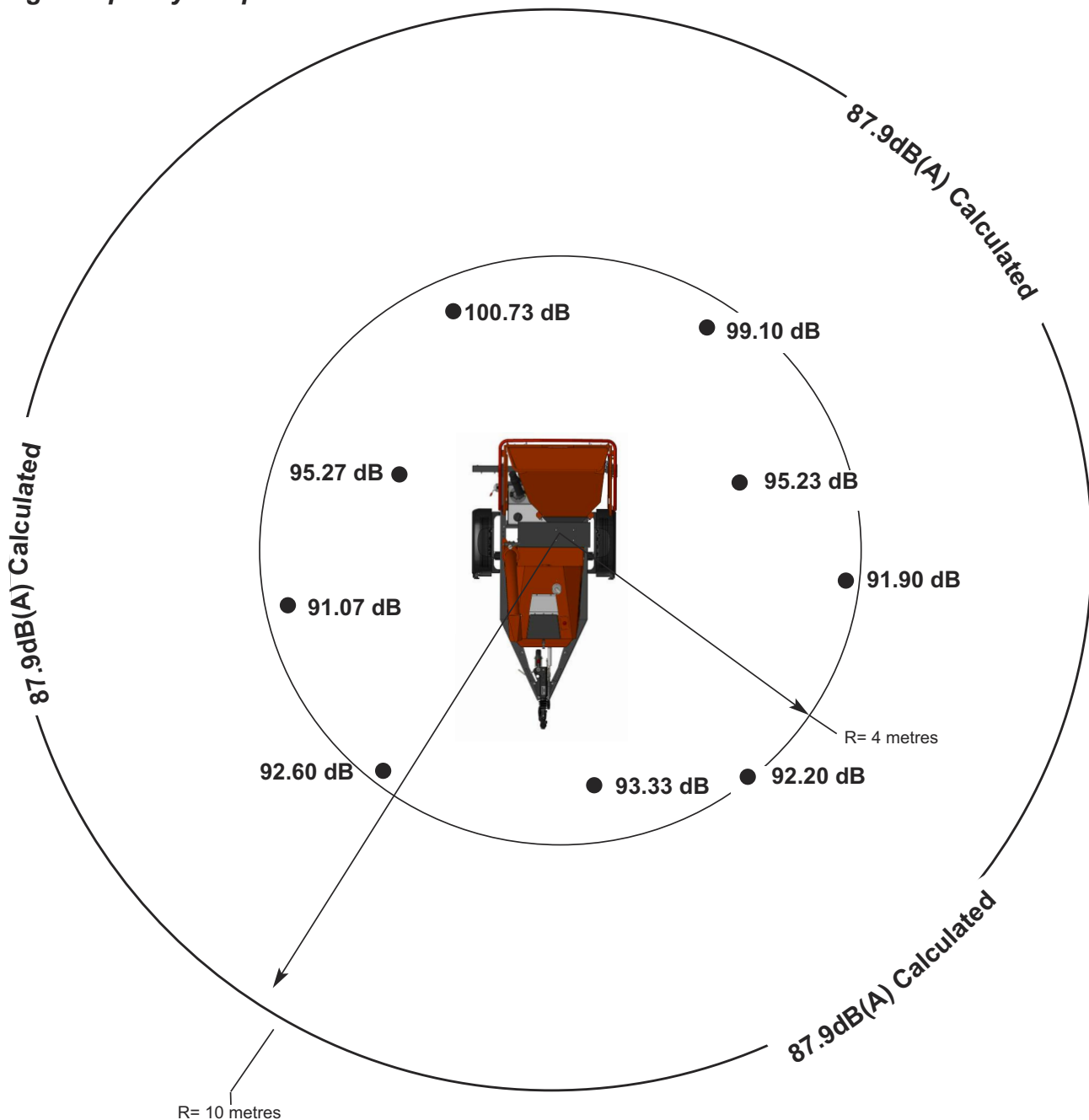

Guaranteed Sound Power: 118dB (A)

As required by Annex III of Directive 2000/14/EC "Noise Emission in the environment by equipment for use outdoors".



SAFE TRANSPORTATION

- WHEN towing a chipper the maximum speed limit is 60 mph.
- ON rough or bumpy road surfaces reduce speed accordingly to protect your machine from unnecessary vibration.
- WHEN towing off road be aware of objects that may catch the chipper undergear.
- WHEN towing off road ensure inclination is not excessive.
- AVOID excessively pot holed ground.

WARNING

DO NOT RIDE ON THE CHIPPER WHEN IT IS BEING TOWED.



- WHEN reversing the chipper the short wheel base will react quickly to steering.
- ALWAYS check the discharge is tight before moving.
- KEEP tyre pressures inflated to 3.4 bar or 50 psi.
- CHECK wheel nuts are tightened to 90Nm or 65 lbs ft.
- CLEAR loose chippings and debris from the machine before departing.
- ENSURE feed funnel is closed and the catch is properly engaged before departing.

HITCHING ONTO THE TOW BALL

- CHECK ball head is well greased.
- WIND jockey wheel assembly anticlockwise until the tow head is above the height of the ball hitch on the vehicle.
- REVERSE vehicle so the ball hitch is directly below the tow head.
- ATTACH breakaway cable to a strong point on the vehicle, not the ball hitch.
- GRASP handle on tow head and push back catch with thumb.
- WIND jockey wheel assembly clockwise, to lower the tow head onto the ball hitch.
- RELEASE handle and continue to wind jockey

wheel clockwise. The tow head should snap into place on the ball hitch. If it doesn't, repeat previous 2 steps.

- WIND jockey wheel up until fully retracted and the jockey wheel frame is seated in its notch on the stem. The chipper weight should be fully on the vehicle.
- RELEASE jockey wheel clamp and slide the jockey wheel assembly fully up.
- TIGHTEN clamp on jockey wheel assembly.
- CONNECT electrical plug to socket on rear of towing vehicle and check operation of all the trailer and vehicle lights.
- THE chipper is now properly attached to the vehicle.

UNHITCHING THE CHIPPER

- ENSURE the chipper will not roll away after being disconnected from the vehicle.
- DISCONNECT the electrical cable from the vehicle socket.
- RELEASE breakaway cable.
- RELEASE the jockey wheel assembly clamp.
- LOWER the jockey wheel assembly fully.
- RETIGHTEN the jockey wheel assembly clamp.
- WIND the jockey wheel assembly anticlockwise until it

starts to take the weight of the chipper.

- GRASP the handle and release the catch with your thumb.
- CONTINUE to wind the jockey wheel anticlockwise. This should lift the tow head clear of the ball hitch.
- DRIVE the vehicle clear of the chipper.
- WIND the jockey wheel assembly to a suitable point where the chipper is level.
- THE chipper is now fully detached from the vehicle.

STABILISING THE CHIPPER

When hitched to a vehicle the chipper handbrake should be released and the jack stand and jockey wheel stored in the towing position (a).

When the chipper is unhitched it should be made secure before starting work by applying the handbrake and lowering the jack stand and jockey wheel (b).





DELIVERY

All Timberwolf TW 280TDHB machines have a full pre - delivery inspection before leaving the factory and are ready to use. Read and understand this instruction manual before attempting to operate the chipper. In particular, read pages 5-7 which contain important health and safety information and advice.

OPERATOR'S PERSONAL PROTECTIVE EQUIPMENT REQUIRED

- CHAINSAW safety helmet fitted with visor and recommended ear defenders to an appropriate specification.
- HEAVY-DUTY gloves with elasticated wrist area.
- CLOSE - FITTING heavy-duty non-snag clothing.
- SAFETY footwear.
- FACE MASK (if appropriate).

See page 5 for more detailed information.

MANUAL CONTROLS

Roller control boxes- a control box is located on either side of the feed funnel. Their function is to control the feed roller whilst processing material. **They do not control the main rotor.**

RED SAFETY BAR = This is the large red bar that surrounds the feed tray and side of the feed funnel. The bar is spring loaded and connected to a switch that will interrupt the power to the rollers. The switch is designed so that it only activates if the bar is pushed to the limit of its travel. The rollers stop instantly, but can be made to turn again by pressing either the **GREEN FEED** or **BLUE REVERSE** control buttons.

WARNING

DO NOT remove, jam, disable, bypass, override or otherwise impede the effectiveness of the red safety bar.



GREEN BUTTON = Forward feed - Push the button once - this activates the rollers and will allow you to start chipping (if the rotor speed is high enough).

BLUE BUTTON = Reverse feed - allows you to back material out of the rollers. The rollers will only turn in reverse as long as you keep pressing the button.

Control Box Diagram

There are two control boxes, located on either side of the feed tray.

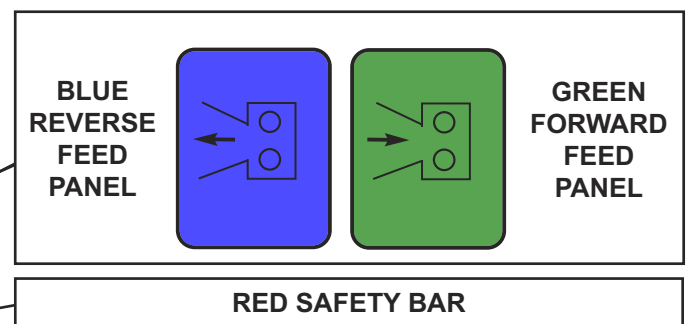

Do not rely on the red bar to keep the roller stationary if it is necessary to clear or touch the roller. Always switch off the machine and remove ignition key before approaching the roller.



AUTO CONTROLS

The engine management unit controls the feed rate of the material going into the chipping chamber. If the engine speed is below the predetermined level, the engine management unit will not allow the feed rollers to work in the forward “infeed” direction, until the rotor speed rises above the predetermined level. At this point, the feed rollers will start turning without warning. The reverse function will work at any engine speed.

EMERGENCY STOPPING

There are two ways of stopping the TW 280TDHB chipper in the event of an emergency.

STOPPING THE ROLLERS

-Activating the red safety bar will stop the rollers immediately. To restart the rollers, just push the green forward button or blue reverse button.

STOPPING THE ENGINE

Should the entire machine need to be stopped in an emergency, the red button on top of the engine guard should be pushed. This will shut down the engine in the shortest possible time. The engine cannot be restarted until the button is pulled out and the main ignition switch is turned off to reset the machine.

DAILY CHECKS BEFORE STARTING

- LOCATE the machine on firm level ground.
- CHECK machine is well supported and cannot move.
- CHECK jack stand is lowered and secure.
- CHECK all guards are fitted and secure.
- CHECK the discharge unit is in place and fastened securely.
- CHECK discharge tube is pointing in a safe direction.
- CHECK the feed funnel to ensure no objects are inside.
- CHECK feed tray is in up position - to prevent people reaching rollers.
- CHECK controls as described on page 11.
- CHECK (visually) for fluid leaks.
- CHECK fuel and hydraulic oil levels.

For parts location see diagrams on pages 3 & 4.

DISCHARGE CONTROLS

Controlling the discharge is an essential part of safe working.

ROTATION

1. Slacken nut using integral handle.
2. Rotate tube.
3. Retighten nut.

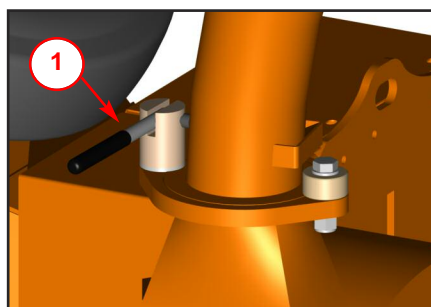

BUCKET ANGLE

4. Adjust the bucket to the desired angle using the handle provided.

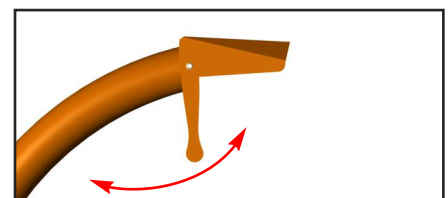



BEFORE USING THE CHIPPER

IT IS ESSENTIAL TO CARRY OUT THE FOLLOWING TESTS to check safety equipment - this sequence of tests will only take a few seconds to carry out. We recommend that these tests are carried out daily. Observing the function as described will confirm that the safety circuits are working correctly. This is also a good opportunity to remind all operators of the control and emergency stop systems.

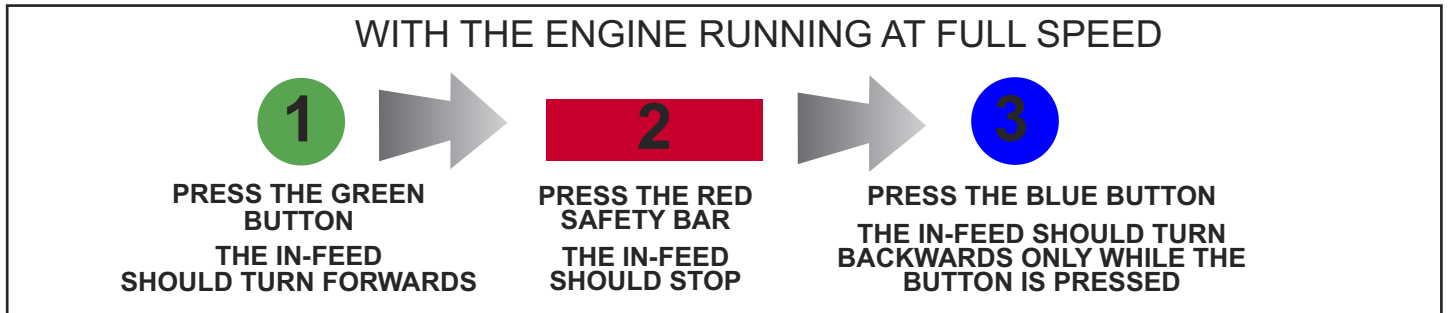

ENGINE CONTROLS

The engine controls are in two locations. The engine ignition is on the control panel in the centre of the machine, and the throttle lever is on the bonnet next to the engine emergency stop switch (see parts locator on page 3).

STARTING THE ENGINE

- ENSURE throttle lever is in the slow (tortoise) position.
- INSERT key. Turn to heat.
- HEATER LED comes on.
- WAIT FOR HEATER LED TO GO OUT.
- TURN key to engage starter motor.
- RELEASE key once engine starts.

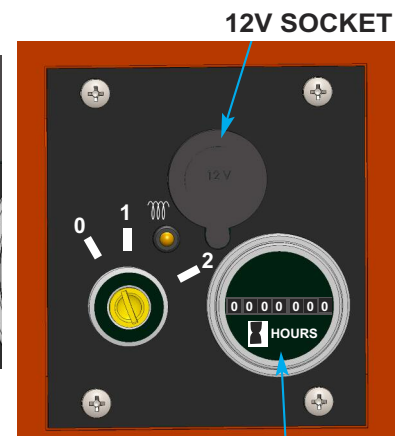
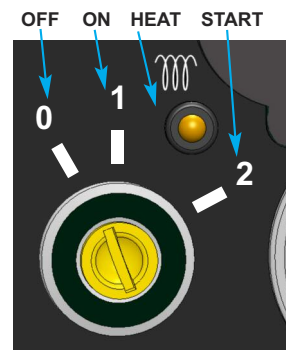

Do not engage starter motor for more than 20 seconds - allow one minute before attempting to start. Investigate reasons for failure to start.

When the emergency stop button is pressed it must be pulled out again and the ignition switch turned off to reset the machine before attempting to restart.

CONTROLLING THE ENGINE SPEED

The engine has two throttle settings, idle and fast. These are controlled by the throttle lever on the funnel. Moving the lever towards the 'Hare' on the pictogram will increase engine speed while moving it towards the 'Tortoise' will decrease engine speed.

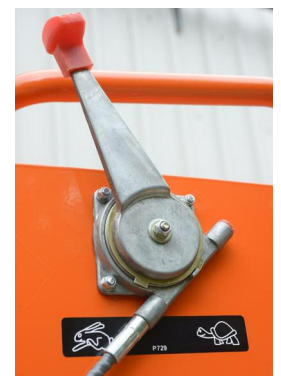

STOPPING THE ENGINE

- MOVE the throttle lever to the 'Tortoise' to reduce the engine speed to idle.
- LEAVE the engine running for 1 minute.
- TURN the power switch to position 0. The engine should stop after a few seconds.
- REMOVE the ignition key.

For more detailed information refer to the Engine Owner's Manual



BLADE WEAR

The most important part of using a wood chipper is keeping the cutter blades sharp. Timberwolf chipper blades are hollow ground to an angle of 40 degrees. When performing daily blade checks ensure blade edge is sharp and free from chips, if there is any evidence of damage, or the edge is "dull" change the blade(s). The TW 280TDHB is fitted with 2 blades 158mm (6") long. It is 100 mm wide when new. A new blade should chip for up to 25 hours before it requires sharpening. This figure will be drastically reduced by feeding the machine with stony, sandy or muddy material.

As the blade becomes blunt, performance is reduced. With increased stress and load on the machine the chips will become more irregular and stringy. At this point the blade should be sent to a reputable blade sharpening company. The blade can be sharpened several times in its life. A wear mark on the reverse side indicates the safe limit of blade wear. Replace when this line is exceeded.

The machine is also fitted with a static blade (anvil). It is important that the anvil is in good condition to allow the cutting blades to function efficiently. Performance will be poor, even with sharp cutter blades, if the anvil is worn.

STARTING TO CHIP

WARNING

Do not use or attempt to start the chipper without the protective guarding and discharge unit securely in place. Failure to do so may result in personal injury or loss of life.



- CHECK that the chipper is running smoothly.
- RELEASE the catches on the feed tray and lower. Pull to release the red stop button.
- PERFORM the "before using the chipper" tests (see page 11).
- WHEN the chipper is unhitched it should be made secure before starting work by applying
- the handbrake and lowering the jack stand and jockey wheel
- PRESS the green control button. The rollers will commence turning.
- STAND to one side of the feed funnel.
- PROCEED to feed material into the feed funnel.

CHIPPING

Wood up to the recommended diameter can be fed into the feed funnel. Put the butt end in first and engage it with the feed roller. The hydraulic feed rollers will pull the branch into the machine quite quickly. Large diameter material will have its feed rate automatically controlled by the engine management unit.

Sometimes a piece of wood that is a particularly awkward shape is too strong for the feed rollers to break. This will cause the top roller to either bounce up and down on the wood or both rollers to stall. If this occurs press the **BLUE REVERSE** button until the material has been released. Pull the material out of the feed funnel and trim it so the chipper can handle it.

Both feed rollers should always turn at the same speed. If one or both rollers stop or suddenly slow down it may be that a piece of wood has become stuck behind one of the rollers. If this occurs press the **BLUE REVERSE** button and hold for 2 seconds - then repress **GREEN FEED** button. This should enable the rollers to free the offending piece of material and continue rotation at the correct speed. If the rollers continue to stall in the 'forward feed' or 'reverse feed' position push the **RED STOP BUTTON**, turn engine off, remove ignition key and investigate.



BLOCKAGES

Always be aware that what you are putting into the chipper must come out. If the chips stop coming out of the discharge tube but the chipper is taking material in - STOP IMMEDIATELY. Continuing to feed material into a blocked machine may cause damage and will make it difficult to clear.

If the chipper becomes blocked, proceed as follows:

- STOP the engine and remove the ignition keys.
- REMOVE the discharge tube. Check that it is clear.
- WEARING gloves, reach into the rotor housing and scoop out the majority of the debris causing the blockage.

WARNING

Do not reach into the rotor housing with unprotected hands. There are sharp blades and any small movement of the rotor may cause serious injury.



- REPLACE the discharge tube.
- RESTART the engine and increase to full speed.
- IN the event of heavy blockages the access hatch can be removed (see parts locator on page 3).

ALLOW machine time to clear excess chips still remaining in rotor housing before you continue feeding brushwood. Feed in a small piece of wood while watching to make sure that it comes out of the discharge. If this does not clear it, repeat the process and carefully inspect the discharge tube to find any obstruction.

NOTE

Continuing to feed the chipper with brushwood once it has become blocked will cause the chipper to compact the chips in the rotor housing and it will be difficult and time consuming to clear.

AVOID THIS SITUATION - WATCH THE DISCHARGE TUBE AT ALL TIMES.

HYDRAULIC OIL LEVEL INDICATOR

This can be viewed through the wall of the tank. Maximum and minimum marks are provided.

FUEL LEVEL INDICATOR

The fuel level can be seen through the wall of the fuel tank.



**THE FOLLOWING PAGES DETAIL ONLY
BASIC MAINTENANCE GUIDELINES SPECIFIC
TO YOUR CHIPPER.**



THIS IS NOT A WORKSHOP MANUAL.

THE FOLLOWING GUIDELINES ARE NOT EXHAUSTIVE AND DO NOT EXTEND TO GENERALLY ACCEPTED STANDARDS OF ENGINEERING/MECHANICAL MAINTENANCE THAT SHOULD BE APPLIED TO ANY PIECE OF MECHANICAL EQUIPMENT AND THE CHASSIS TO WHICH IT IS MOUNTED.

AUTHORISED TIMBERWOLF SERVICE AGENTS ARE FULLY TRAINED IN ALL ASPECTS OF TOTAL SERVICE AND MAINTENANCE OF TIMBERWOLF WOOD CHIPPERS. YOU ARE STRONGLY ADVISED TO TAKE YOUR CHIPPER TO AN AUTHORISED AGENT FOR ALL BUT THE MOST ROUTINE MAINTENANCE AND CHECKS.

TIMBERWOLF ACCEPTS NO RESPONSIBILITY FOR THE FAILURE OF THE OWNER/USER OF TIMBERWOLF CHIPPERS TO RECOGNISE GENERALLY ACCEPTED STANDARDS OF ENGINEERING/MECHANICAL MAINTENANCE AND APPLY THEM THROUGHOUT THE MACHINE.

**THE FAILURE TO APPLY GENERALLY ACCEPTED
STANDARDS OF MAINTENANCE, OR THE PERFORMANCE
OF INAPPROPRIATE MAINTENANCE, MAY INVALIDATE
WARRANTY IN WHOLE OR IN PART.**

**PLEASE REFER TO YOUR AUTHORISED
TIMBERWOLF SERVICE AGENT FOR
SERVICE AND MAINTENANCE.**





SERVICE SCHEDULE

WARNING

Always immobilise the machine by stopping the engine, removing the ignition key and disconnecting the battery before undertaking any maintenance work.



SERVICE SCHEDULE	Daily Check	50 Hours	100 Hours	500 Hours	1 Year
Check water.	✓				
Check radiator is clear.	✓				
Check engine oil - top up if necessary (10W-30).	✓				
Check for engine oil / hydraulic oil leaks.	✓				
Check fuel level.	✓				
Check feed funnel, feed roller cover, access covers, engine covers and discharge unit are securely fitted.	✓				
Check blades.	✓				
Clean air filter element.	DEPENDING ON WORKING ENVIRONMENT				
Check tyre pressure is 3.4 Bar (50 psi).	✓				
Check safety bar mechanism.	✓				
Check for tightness all nuts, bolts and fastenings making sure nothing has worked loose.		✓			
Grease discharge flange.		✓			
Check tension of main drive belts (and tension if necessary).		✓			
Grease the roller box slides.	✓		OR AS REQUIRED - SEE PAGE 21		
Grease the roller spline and bearing.	✓		OR AS REQUIRED - SEE PAGE 21		
Check anvils for wear.		✓			
Check fuel pipes and clamp bands.			✓		
Check for loose electrical wiring.			✓		
Replace hydraulic oil filter - every year or 100 hours after service or repair work to the hydraulic system.			✓	OR	✓
Replace hydraulic oil.			✓	OR	✓
Replace fuel pipes and clamp bands.	<div style="display: flex; align-items: center; justify-content: center;"> <div style="font-size: 3em; margin-right: 10px;">}</div> <div style="text-align: center;"> <p>REFER TO YOUR ENGINE SUPPLIERS MANUAL</p> </div> </div>				
Check coolant.					
Change engine oil.					
Replace engine oil filter cartridge.					
Check valve clearance.	<div style="display: flex; align-items: center; justify-content: center;"> <div style="font-size: 3em; margin-right: 10px;">}</div> <div style="text-align: center;"> <p>RETURN TO DEALER FOR ANVIL CHANGE</p> </div> </div>				
Replace anvils when worn.					
Axle maintenance.	<div style="display: flex; align-items: center; justify-content: center;"> <div style="font-size: 3em; margin-right: 10px;">}</div> <div style="text-align: center;"> <p>REFER TO SUPPLIERS INSTRUCTION SHEET</p> </div> </div>				
Tow head maintenance.	<div style="display: flex; align-items: center; justify-content: center;"> <div style="font-size: 3em; margin-right: 10px;">}</div> <div style="text-align: center;"> <p>REFER TO SUPPLIERS INSTRUCTION SHEET</p> </div> </div>				

To assess the wear condition of the braking system, and troubleshoot any problems relating to the braking system or axle, please refer to the 'Brake Operation Handbook' and 'AL-KO document 580458' as supplied.

NOTE: Your Timberwolf woodchipper is covered by a full 12 months parts and labour warranty. Subject to correct maintenance and proper machine usage, the bearings are guaranteed for 12 months regardless of hours worked by the machine. In conditions of 'heavy usage' - i.e. in excess of 500 hours per year - it is recommended that the bearings are changed annually to ensure that the machine retains optimum working performance.



SAFE MAINTENANCE

ALWAYS IMMOBILISE THE ENGINE BEFORE UNDERTAKING ANY MAINTENANCE WORK ON THE CHIPPER BY REMOVING THE KEY AND DISCONNECTING THE BATTERY.

- HANDLE blades with extreme caution to avoid injury. Gloves should always be worn when handling the cutter blades.
- THE drive belts should be connected while changing blades, as this will restrict sudden movement of the rotor.
- THE major components of this machine are heavy. Lifting equipment must be used for disassembly.
- CLEAN machines are safer and easier to service.
- AVOID contact with hydraulic oil.

SAFE LIFTING OF THE CHIPPER

The lifting eye is designed to lift the machine's weight only. Do not use hoist hook directly on the lifting eye, use a correctly rated safety shackle. Inspect the lifting eye prior to each use - **DO NOT USE LIFTING EYE IF DAMAGED.**

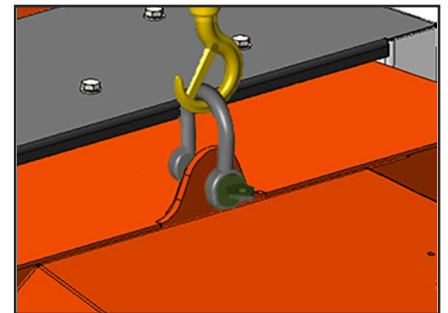

SPARES

Only fit genuine Timberwolf replacement blades, screws and chipper spares. Failure to do so will result in the invalidation of the warranty and may result in damage to the chipper, personal injury or even loss of life.

BATTERY REMOVAL AND MAINTENANCE

WARNING

Refer to the battery safety section on page 17 - 18.



1. The battery can be located under the funnel.
2. Remove the negative lead first and then the positive lead.
3. Clean, charge and/or top up the battery as required.
4. Refitting is the reverse of removal. Apply a smear of vaseline to the terminals to prevent corrosion.

CHECK FITTINGS

The Timberwolf TW 280TDHB is subject to large vibrations during the normal course of operation. Consequently there is always a possibility that nuts and bolts will work themselves loose. It is important that periodic checks are made to ensure the security of all fasteners. Fasteners should be tightened using a torque wrench to the required torque (see below). **Uncalibrated torque wrenches can be inaccurate by as much as 25%. It is therefore essential that a calibrated torque wrench is used to achieve the tightening torques listed below.**

	Size	Pitch	Head	Torque lb ft
Blade Bolts	M16	Standard	24mm Hex	125
Anvil Bolts	M12	Standard	10mm Allen Hex	65
General	M8	Standard	13 mm Hex	20
General	M10	Standard	17 mm Hex	45
General	M12	Standard	19 mm Hex	65
Drain Bung in Fuel Tank	3/8" BSP	-	22 mm Hex	25



COPPER EASE SAFETY INFORMATION

Product name: Copper Ease.

Copper Ease contains no hazardous ingredients at or above regulatory disclosure limits, however, safety precautions should be taken when handling (use of oil-resistant gloves and safety glasses are recommended - respiratory protection is not required). Avoid direct contact with the substance and store in a cool, well ventilated area avoiding sources of ignition, strong oxidising agents and strong acids. Dispose of as normal industrial waste (be aware of the possible existence of regional or national regulations regarding disposal), do not discharge into drains or rivers.

In case of fire: in combustion the product emits toxic fumes, extinguish with alcohol or polymer foam, carbon dioxide or dry chemical powder. Wear self-contained breathing apparatus and protective clothing to prevent contact with skin and eyes.

FIRST AID

Skin contact: there may be mild irritation at the site of contact, wash immediately with plenty of soap and water.

Eye contact: there may be irritation and redness, bathe the eye with running water for 15 minutes.

Ingestion: there may be irritation of the throat, do not induce vomiting, wash out mouth with water.

A safety data sheet for this product can be obtained by writing to the manufacturer at the following address: Comma Oil and Chemicals Ltd., Deering Way, Gravesend, Kent DA12 2QX. Tel: 01474 564311, Fax: 01474 333000.

BATTERY SAFETY INFORMATION

WARNING NOTES AND SAFETY REGULATIONS FOR FILLED LEAD-ACID BATTERIES



For safety reasons, wear eye protection when handling a battery.



Keep children away from acid and batteries.



Fires, sparks, naked flames and smoking are prohibited.
-Avoid causing sparks when dealing with cables and electrical equipment, and beware of electrostatic discharges.
-Avoid short circuits.



Explosion hazard:
-A highly explosive oxyhydrogen gas mixture is produced when batteries are charged.



Corrosive hazard:
-Battery acid is highly corrosive, therefore:
-Wear protective gloves and eye protection.
-Do not tilt the battery, acid may escape from the vent openings.



First aid:
-Rinse off acid splashed in the eyes immediately for several minutes with clear water! Then consult a doctor immediately.
-Neutralise acid splashes on the skin or clothes immediately with acid neutraliser (soda) or soap suds, and rinse with plenty of water.
-If acid is swallowed, consult a doctor immediately.

Warning notes: The battery case can become brittle, to avoid this:



-Do not store batteries in direct sunlight.
-Discharged batteries may freeze up, therefore store in an area free from frost.



Disposal:
-Dispose of old batteries at an authorised collection point.



-The notes listed under item 1 are to be followed for transport.
-Never dispose of old batteries in household waste.



BATTERY SAFETY INFORMATION...cont.

1. Storage and transport

- Batteries are filled with acid.
- Always store and transport batteries upright and prevent from tilting so that no acid can escape.
- Store in a cool and dry place.
- Do not remove the protective cap from the positive terminal.
- Run a FIFO (first in-first out) warehouse management system.

2. Initial operation

- The batteries are filled with acid at a density of 1.28g/ml during the manufacturing process and are ready for use.
- Recharge in case of insufficient starting power (cf. section 4).

3. Installation in the vehicle and removal from the vehicle

- Switch off the engine and all electrical equipment.
- When removing, disconnect the negative terminal first.
- Avoid short circuits caused by tools, for example.
- Remove any foreign body from the battery tray, and clamp battery tightly after installation.
- Clean the terminals and clamps, and lubricate slightly with battery grease.
- When installing, first connect the positive terminal, and check the terminal clamps for tight fit.
- After having fitted the battery in the vehicle, remove the protective cap from the positive terminal, and place it on the terminal of the replaced battery in order to prevent short circuits and possible sparks.
- Use parts from the replaced battery, such as the terminal covers, elbows, vent pipe connection and terminal holders (where applicable); use available or supplied filler caps.
- Leave at least one vent open, otherwise there is a danger of explosion. This also applies when old batteries are returned.

4. Charging

- Remove the battery from the vehicle; disconnect the lead of the negative terminal first.
- Ensure good ventilation.
- Use suitable direct current chargers only.
- Connect the positive terminal of the battery to

the positive output of the charger. Connect the negative terminal accordingly.

- Switch on the charger only after the battery has been connected, and switch off the charger first after charging has been completed.
- Charging current-recommendation: 1/10 ampere of the battery capacity Ah.
- Use a charger with a constant charging voltage of 14.4V for re-charging.
- If the acid temperature rises above 55° Celsius, stop charging.
- The battery is fully charged when the charging voltage has stopped rising for two hours.

5. Maintenance

- Keep the battery clean and dry.
- Use a moist anti-static cloth only to wipe the battery, otherwise there is a danger of explosion.
- Do not open the battery.
- Recharge in case of insufficient starting power (cf. section 4).

6. Jump Starting

- Use the standardised jumper cable in compliance with DIN 72553 only, and follow the operating instructions.
- Use batteries of the same nominal voltage only.
- Switch off the engines of both vehicles.
- First connect the two positive terminals (1) and (2), then connect the negative terminal of the charged battery (3) to a metal part (4) of the vehicle requiring assistance away from the battery.
- Start the engine of the vehicle providing assistance, then start the engine of the vehicle requiring assistance for a maximum of 15 seconds.
- Disconnect the cables in reverse sequence (4-3-2-1).

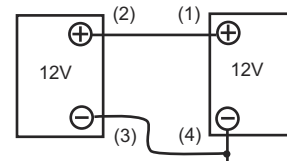

7. Taking the battery out of service

- Charge the battery; store in a cool place or in the vehicle with the negative terminal disconnected.
- Check the battery state of charge at regular intervals, and correct by recharging when necessary (cf. section 4).



CHANGE BLADES

WARNING

Wear riggers gloves for the blade changing operation.

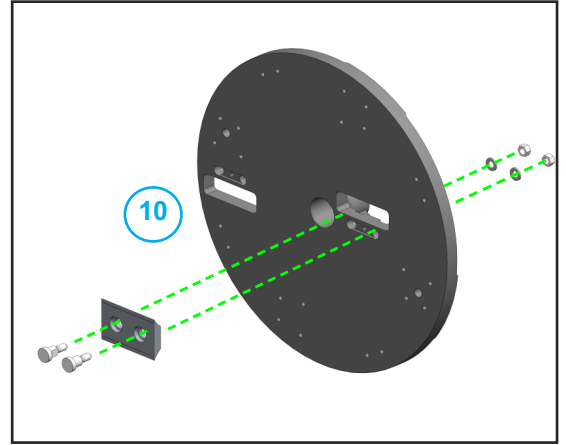
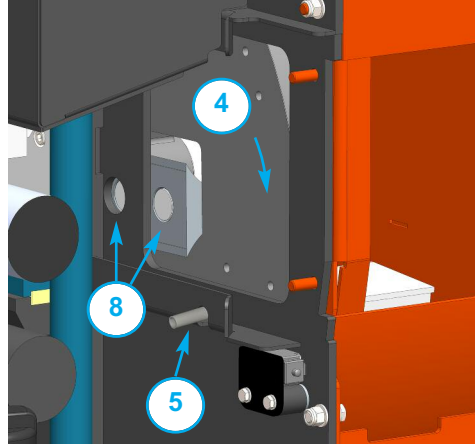
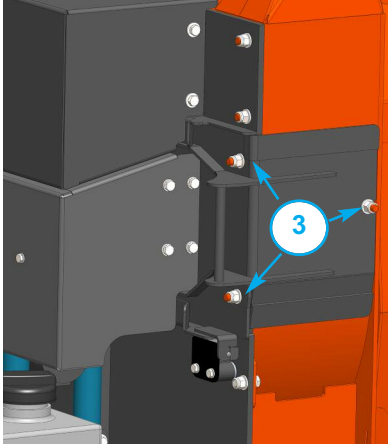

- 1 Turn the chipper off and remove the ignition keys.
- 2 Remove battery leads.
- 3 Remove the 3 nuts retaining the access hatch, slide hatch clear of rotor housing.
- 4 Turn rotor to blade change position.
- 5 Insert locking bar into rotor housing and rotor.
- 6 Brush away all dirt and debris from the rotor and blades.
- 7 With a 24mm spanner/socket undo the 2 nyloc nuts and washers that are holding the blade in place.
- 8 Remove blade bolts while holding blade in position. The inner bolt on the inner blade passes through the hole in the roller box. If necessary tap the bolts to loosen.
- 9 Grasp the blade by the flat edges while wearing heavy duty gloves.
- 10 Withdraw the blade from the rotor.
- 11 Rotate blade to use 2nd edge or replace with a new or sharpened blade.
- 12 Clean the back surface of the blade, blade bolts and blade area of the rotor before reseating blades. **The blades must not have any material underneath them when tightened. If they are not flat and tight they will become loose very quickly.**
- 13 Reassemble the blades, bolts, washers and nuts in the order shown in the diagram above. Use only genuine Timberwolf nuts and washers, as they are of a higher grade than normally stocked at fastener factories. Failure to use the appropriate grade nuts or washers may result in damage, injury or death. The use of genuine Timberwolf blades and bolts is recommended.
- 14 Apply a smear of anti seize compound (copper ease) to the bolt threads and back face of the nuts. Do not apply copper grease onto the counter bore faces of the blades or bolts.
- 15 **A calibrated torque wrench must be used to tighten the bolts to a torque setting of 125 lbs ft (170 Nm).**
- 16 Remove lock pin, rotate rotor to next blade then replace lock pin and repeat steps 6 - 14.
- 17 Refit access hatch.
- 18 Refit the nuts and tighten to 40lb/ft.
- 19 Refit battery leads.

WARNING

Always sharpen blades on a regular basis. Failure to do so will cause the machine to under perform and will overload engine and bearings causing machine breakdown. Blades must not be sharpened beyond the wear mark (see diagram). Failure to comply with this could result in machine damage, injury or loss of life.

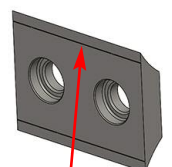

WEAR MARK



TENSION DRIVE BELTS

NOTE: There will normally be a rapid drop in tension during run-in period for new belts. When new belts are fitted, check the tension every 2 - 3 hours and adjust until the tension remains constant.

Belt failures due to lack of correct tensioning will not be covered under your Timberwolf warranty.

1. Remove side panel.
2. Loosen bolt in centre of tensioner pulley with a 19 mm spanner so that pulley is able to slide with minimal wobble.
3. Turn nut in end of tensioner pulley slider until correct belt tension is achieved. For instructions on checking belt tension & correct belt tension values, please refer to the Timberwolf V-Belt Tensioning Data Table at the end of the manual.
5. Re-tighten bolt in centre of tensioner pulley.
6. Run machine and test, recheck belt tension.
7. **NOTE:** Slack drive belts will cause poor performance and excess belt and pulley wear.

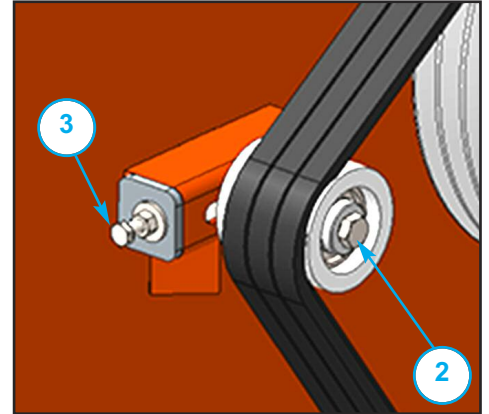

CHANGE HYDRAULIC OIL AND FILTER

WARNING

Use plastic gloves to keep oil off skin and dispose of the used oil and filter in an ecologically sound way. The oil and filter should be changed once a year or at any time it becomes contaminated. Before starting check that the chipper is standing level and brush away loose chips.

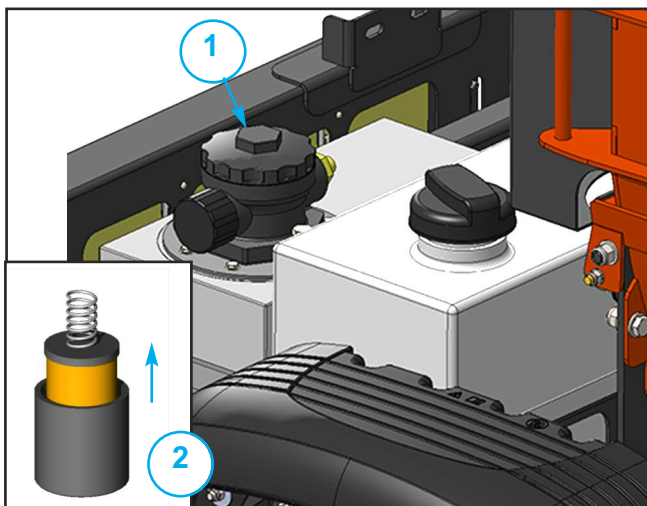

NOTE: This is a non-adjustable air breather filter.

1. Remove the black screw cap from the top of the filter housing.
2. Partially remove filter element from inner cup. Leave filter to drain for 15 minutes.
3. Remove filter element from cup when clear of hydraulic oil.
4. Remove drain plug and drain oil into a suitable container.
5. Replace drain plug.
6. Refill with VG 32 hydraulic oil until the level is between the min and max lines on the tank (about 15 litres).
7. Refit the filter cup, install a new filter element and refit the black screw cap, to the filter housing, ensuring o-ring remains in place.

CHECK HOSES

All the hydraulic hoses should be regularly inspected for chafing and leaks. The hydraulic system is pressurized to 150 Bar (2175 PSI) and thus the equipment containing it must be kept in good condition.

Identify the hoses that run to the top motor. These have the highest chance of damage as they are constantly moving. If any hydraulic components are changed new seals should be installed during reassembly. Fittings should then be retightened.



GREASE THE ROLLER SPLINE AND ROTOR BEARINGS

NOTE: This should be done regularly. In dirty and dusty conditions or during periods of hard work it should be daily. If the bearings and splines are allowed to run dry premature wear will occur resulting in a breakdown and the need for replacement parts. This failure is not warranty. Early signs of insufficient grease includes squeaking or knocking rollers.

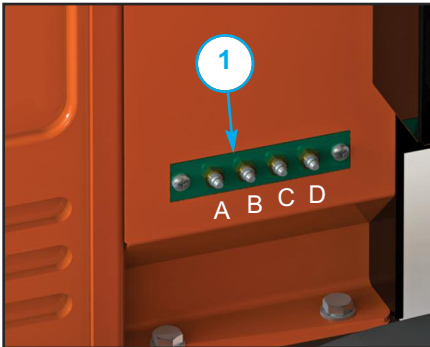

1. Locate the greasing panel.
2. Apply 4+ pumps of grease to each nipple.
3. It is recommended to grease all the nipples whilst the engine is running and rollers are turning to distribute the grease evenly.
DO NOT USE GRAPHITE BASED GREASE.
4. Both front and rear bearings are greased by nipples A and B. The top and bottom roller splines are greased by nipples C and D.

GREASE THE ROLLER BOX SLIDES

NOTE: This should be done regularly. In dirty or dusty conditions or during periods of hard work it should be done weekly. If the slides become dry the top roller will tend to hang up and the pulling-in power of the rollers will be much reduced. Excessive wear will ensue.

1. Turn the chipper off and remove the ignition keys.
2. Ensure machine has come to a complete stop - remove battery leads.
3. Remove the 6 nuts and washers retaining the roller box guard and remove guard.
4. Remove the blade access hatch as blade change procedure.
5. Apply thin grease with a brush directly to the slide surfaces indicated, including inner cheeks of slider. **DO NOT USE GRAPHITE BASED GREASE.**
6. Replace access hatch then top guard. Refit nuts and washers.
7. Refit battery leads.

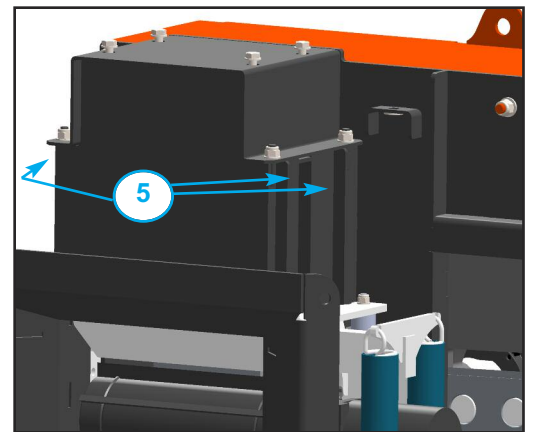
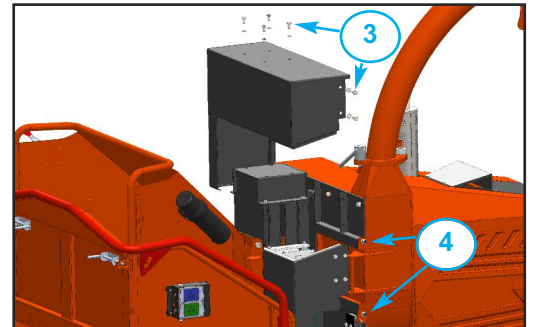

GREASE THE DISCHARGE FLANGE

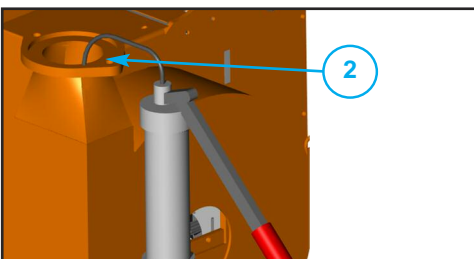

1. Remove the discharge tube.
2. Apply multipurpose grease to surface shown.
3. Refit discharge tube.

ENGINE SERVICING

All engine servicing must be performed in accordance with the Engine Manufacturer's Handbook provided with the machine. **FAILURE TO ADHERE TO THIS MAY INVALIDATE WARRANTY AND/OR SHORTEN ENGINE LIFE.**



ENTEC INDUSTRIES LTD 36 MONTH WARRANTY

WARRANTY

The warranty period for your Entec Industries Ltd machine commences on the date of sale to the first end user and continues for a period of 36 months. This guarantee is to the first end user only and is not transferable except when an Authorised Timberwolf Dealer has a machine registered with Entec Industries Ltd as a hire chipper or long term demonstrator – in these situations they are duly authorised to transfer any remaining warranty period to their first end user. Any warranty offered by the Timberwolf Dealer beyond the original 36-month period will be wholly covered by said Dealer.

LIABILITY

No liability will be accepted for special, indirect, incidental, or consequential loss or damages of any kind. Our obligation under this warranty is limited to repair at Entec Industries Ltd Authorised Timberwolf Dealers or at Entec Industries Ltd premises.

WARRANTY STATEMENT

Entec Industries Ltd warrants to the first end user that:

- Your machine shall be designed, built and equipped, at the point of sale, to meet all current applicable regulations.
- Your machine shall be free from manufacturing defects both in materials and workmanship in normal service for the period mentioned above.

Normal wear & tear on consumable items and their routine maintenance or replacement are not warrantable items.

Engine units are covered independently by their respective manufacturer warranties.

OWNERS WARRANTY RESPONSIBILITIES

As the owner of an Entec Industries Ltd machine you are responsible for the following:

- Operation of the machine in accordance with the Entec Industries Ltd instruction manual.
- Performance of the required maintenance listed in your Entec Industries Ltd instruction manual.
- In the event of a failure the Entec Industries Ltd authorised Timberwolf dealer is to be notified within 10 days of failure and the equipment is to be made available for inspection by the dealer technician.

WARRANTY RESTRICTIONS

The Entec Industries Ltd warranty is restricted to the first end user only and is not transferable except when an authorised Timberwolf dealer has a wood chipper registered with Entec Industries Ltd as a hire chipper or long term demonstrator – in these situations they are duly authorised to transfer any remaining warranty period to their first end user.

The Entec Industries Ltd warranty may be invalidated if any of the following apply:

- The failed parts or assembly is interfered with in any way.
- Normal maintenance has not been performed.
- Incorrect reassembly of components.
- The machine has undergone modifications not approved in writing by Entec Industries Ltd.
- In the case of tractor driven equipment, use has been on an unapproved tractor.
- Conditions of use can be deemed abnormal.
- The machine has been used to perform tasks contrary to those stated in the Entec Industries Ltd instruction manual.

WARRANTY SERVICE

To obtain warranty service please contact your nearest Entec Industries Ltd approved Timberwolf dealer. To obtain details of the nearest facility please contact Entec Industries Ltd at the address on the back of this manual. These warranty terms are in addition to and not in substitution for and do not affect any right and remedies which an owner might have under statute or at common law against the seller of the goods under the contract by which the owner acquired the goods.



CERTIFICATE OF CONFORMITY

Environmental Manufacturing LLP

Entec House,
 Tomo Industrial Estate,
 Stowmarket,
 Suffolk IP14 5AY

Tel: 01449 765800 Fax: 01449 765801

EC Declaration of Conformity



Environmental Manufacturing LLP as the designer and manufacturer, certifies that the machine stipulated below complies with all the relevant provisions of the:

Machinery Directive; 2006/42/EC (& other relevant directives)

and the National Laws and Regulations adopting these directives.

Designer/Manufacturer	:	Environmental Manufacturing LLP
Description of Machinery	:	Self-powered portable machine intended to chip up tree waste prior to disposal.
Model	:	TW 280TDHB
Serial No.	:	<u>Serial Manufacture</u>

BSI Transposed Harmonised Standards applied: (including parts/clauses of):

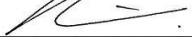

BS EN 12100-1: 2010 Safety of Machinery- Basic concepts, BS EN 13857-1: 2008 Safety of Machinery-Safety distances to danger zones, BS EN 60204-1: 2006 +A1 2009 Safe electrical practices, BS EN 13732-1:2008 Safety of Machinery – Temperatures of touchable surfaces, BS EN 13849-1: 2008 – Safety of Machinery – Safety related parts of control systems, BS13850:2008 safety of Machinery Emergency stop BS EN 982: 1996 + A1 2005 – Safety of Machinery – Hydraulics, BS EN 1088: 1995 + A2 2008 – Safety of Machinery – Interlocking devices, BS EN 13525: 2005 + A2 2009 – Forestry Machinery – Wood chippers – Safety. BS EN 953:1997+A1:2009

“Responsible” Person empowered to sign:  Mr. Jeff Haines
 Position in Company: Technical Director

Date: 15th April 2016



IDENTIFICATION PLATE

		TIMBERWOLF ENVIRONMENTAL MANUFACTURING LLP Entec House, Tomo Industrial Estate, Stowmarket, Suffolk IP14 5AY - UK			
MODEL					KG
SERIAL NO.				0 -	KG
CARR. TYP/SN.				1 -	KG
NOM. PWR				2 -	KG
		GROSS WEIGHT			
		DATE			



Decal	Description	Decal	Description
	616 Hot exhaust		4099 Danger. Rotating blades. Keep hands and feet out.
	617 High velocity discharge - keep clear		2800 Reverse feed
	670 Personal Protective Equipment required		2801 Forward feed
	1661 Read the instruction manual for greasing and maintenance information		19517 Warning Do not engage starter motor for more than 20 seconds. Allow one minute before attempting to start. Investigate reasons for failure to start. Excessive cranking will result in starter motor failure. This will not be covered under warranty.
	1662 The instruction manual with this machine contains important operating, maintenance and health and safety information. Failure to follow the information contained in the instruction manual may lead to death or serious injury.		2949 Lifting eye is designed to lift the machine's weight only. Do not use hoist hook on lifting eye. Use correctly rated safety shackle only through lifting eye. Lifting eye to be inspected every 6 months or before each use. Always visually inspect lifting eye prior to each use. Do not use lifting eye if damaged.
	1399 Push to stop.		3022 Clean under blades before refitting or turning. Failure to do so may result in blade(s) coming loose and damage being caused to the rotor housing.
	P691 Do not pull here.		18393 New drive belts need re-tensioning. When new belts are fitted check tension every 2-3 hours & adjust until tension remains constant.
	P1301 Push to stop, Pull to reset. (engine)		C192-0112 Fuel Here. Risk of fire. Allow engine to cool for 1 minute before refuelling. Use diesel fuel only.



Decal	Description	Decal	Description
	P637 Danger. Do not operate without this cover in place.		P653 Danger. Rotating blades inside. Stop engine and remove key before removing discharge unit.
	P652 Caution. Do not put road sweepings in machine as grit will damage blades.		P654 Caution. When transporting, discharge clamps may work loose. Check frequently.
	P655 Caution. Avoid standing directly in front of feed funnel to reduce exposure to noise, dust and risk from ejected particles.		P656 Danger. Do not use this machine without the discharge unit fitted. Failure to comply may result in serious injury or damage.
	1258 Warning Failure to maintain brake adjustment will result in damper failure. No warranty liability will be accepted on this item.		P650 Danger. Autofeed system fitted. Rollers may turn without warning! When the engine is switched off the rollers will turn during the run down period.
	P1809		P1812 Torque blade bolts to 125 lbs ft (170 Nm).
	P1810		
	P1811		
	C192 - 0100		C192 - 0101
	18008		1363
P*2743		P*2744	
		P*729	

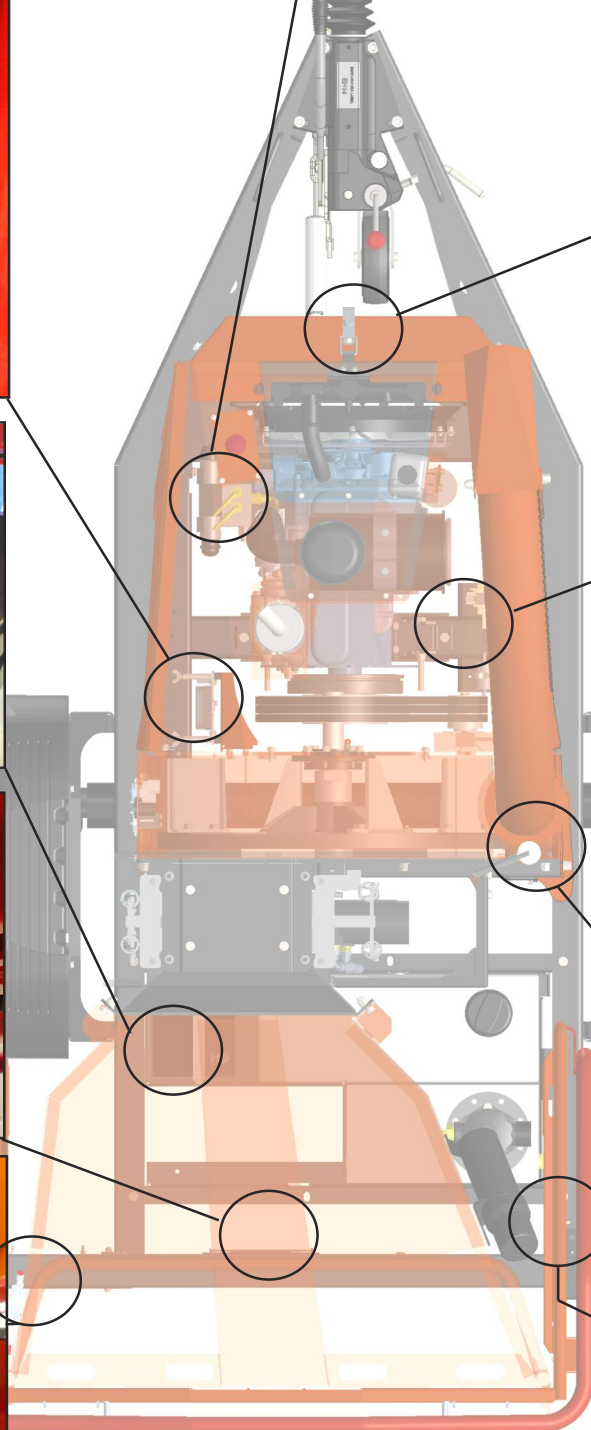
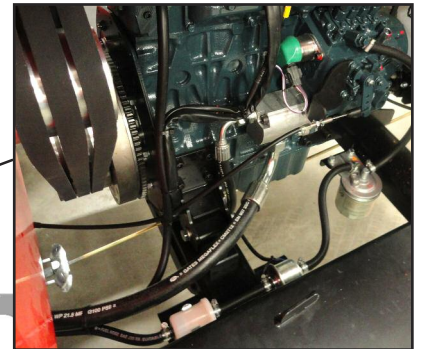
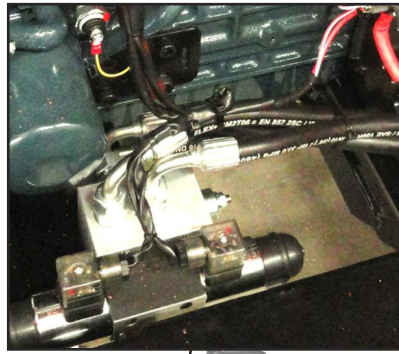

Date Last Modified: 22.04.2016

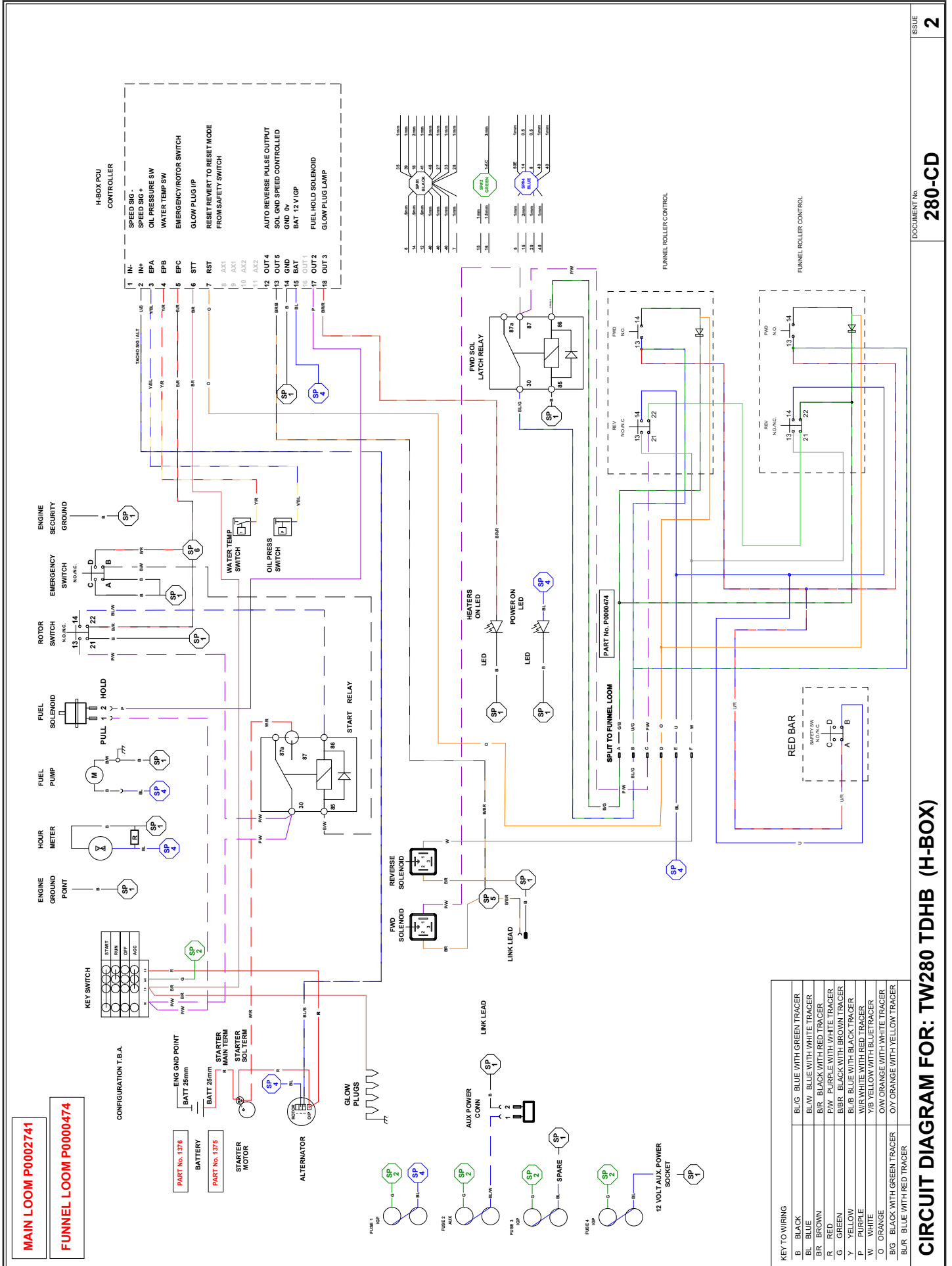

MAIN LOOM P0002741
FUNNEL LOOM P0000474

KEY TO WIRING	WIRE COLOR	WIRE COLOR WITH TRACER
B	BLACK	BLACK WITH GREEN TRACER
BL	BLUE	BLUE WITH WHITE TRACER
BL/W	BLUE WITH WHITE TRACER	BLUE WITH WHITE TRACER
BR	BROWN	BLACK WITH RED TRACER
R	BROWN	PURPLE WITH RED TRACER
G	GREEN	PURPLE WITH WHITE TRACER
Y	YELLOW	BLACK WITH BROWN TRACER
W	WHITE	BLUE WITH BLACK TRACER
W/R	WHITE WITH RED TRACER	WHITE WITH RED TRACER
O	ORANGE	YELLOW WITH BLUE TRACER
B/G	BLACK WITH GREEN TRACER	ORANGE WITH WHITE TRACER
BL/R	BLUE WITH RED TRACER	ORANGE WITH YELLOW TRACER



KIT NO: P1602

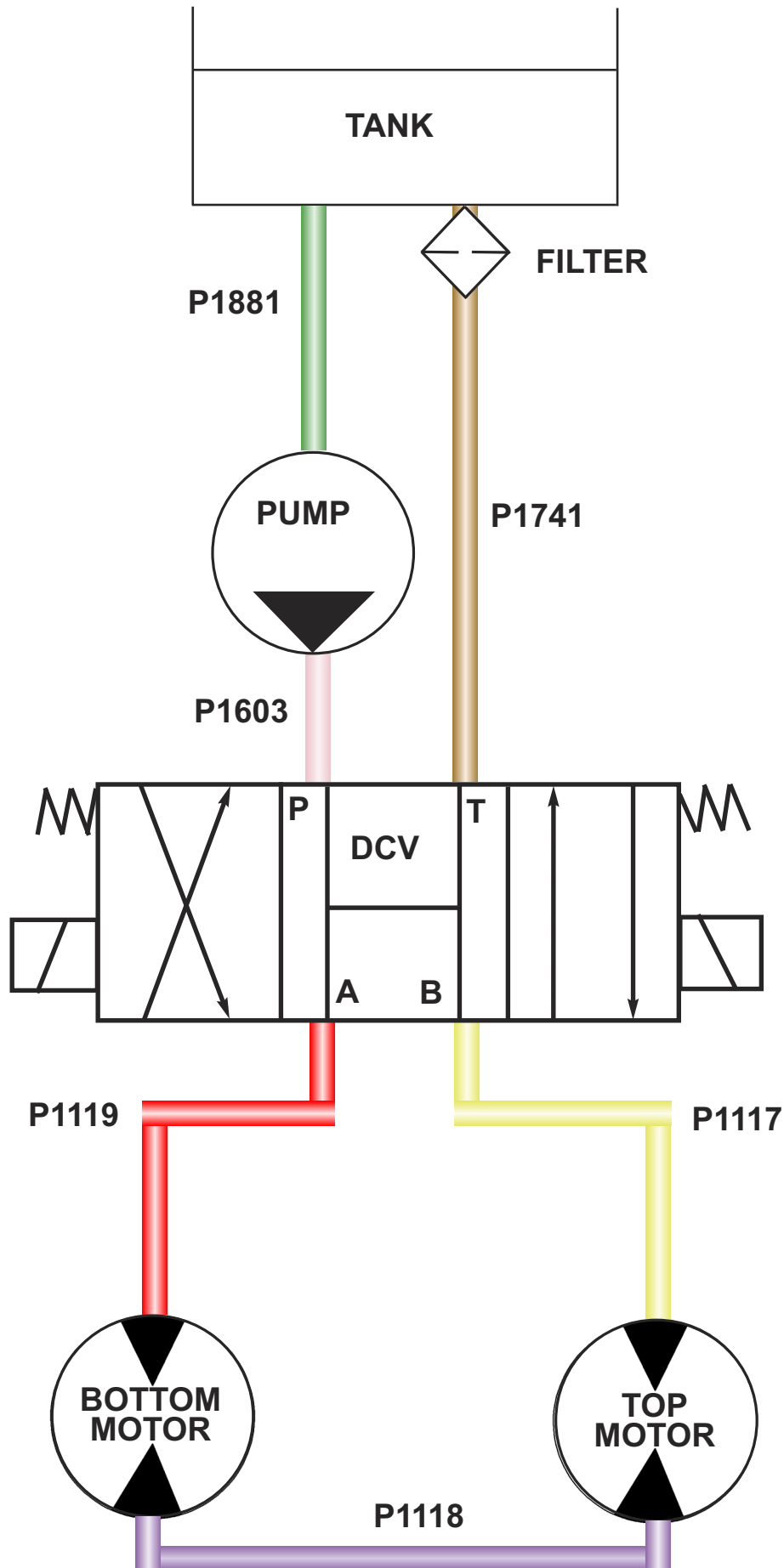



METHOD:

1. Set the deflection distance on the lower scale of the tension gauge so that the underside of the 'o'-ring equals the 'h' value given in the table.
2. Ensure that the deflection force scale is zero'd by pushing the upper 'o'-ring all the way down.
3. Place the tension gauge in the centre of the belt span as shown in the diagram.
4. Press downwards on the rubber buffer, deflecting the belt until the underside of the lower 'o'-ring is level with the belt behind (use a straight edge if there is only 1 belt).
5. Take the reading from the deflection scale of the tension meter (read at the lower edge of the 'o'-ring) & compare this value with that given in the table.
6. Tighten or loosen belts as required following procedure given in this operator's manual.

Tension gauges are available from Timberwolf spares, quoting part no. 18091

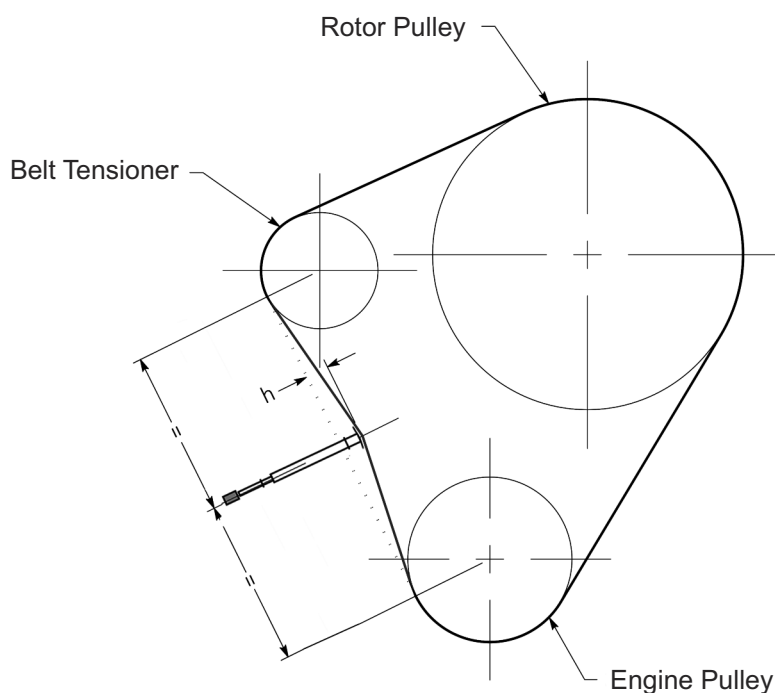

TW Model No.:		18/100G	125PH	160PH	230DHB 230DHB(a)	230VTR	230PWHB 230PWHB(a)	230PAHB 230PAHB(a)	280TDHB 280TDHB(a)	280TFTR	280PHB 280PHB(a)		
Rotor Belts	Belt Mfr / Type	Gates Super HC-MN	Gates Super HC-MN	Gates Super HC-MN	Gates Super HC-MN	Gates Super HC-MN	Gates Super HC-MN	Gates Super HC-MN	Gates Super HC-MN	Gates Super HC-MN	Gates Super HC-MN		
	Belt Pitch Designation	SPA	SPA	SPA	SPA	SPA	SPA	SPA	SPB	SPB	SPB		
	Belt Length in mm	1060	1060	1030	1232	1232	1285	1232	1600	1600	1690		
	Belt Deflection	=	h	2	2	2	3	3	3	3	4	4	4
	Force Reading	New belt	2.92 - 3.14	3.38 - 3.62	3.75 - 4.01	4.58 - 4.91	4.58 - 4.91	4.46 - 4.78	4.81 - 5.15	6.07 - 6.51	5.39 - 5.78	9.14 - 9.79	
	Used Belt	2.51 - 2.72	2.89 - 3.14	3.21 - 3.47	3.93 - 4.25	3.93 - 4.25	3.82 - 4.14	4.12 - 4.47	5.20 - 5.63	4.62 - 5.00	7.83 - 8.48		

TIPS ON BELT TIGHTENING:

- There will normally be a rapid drop in tension during the run-in period for new belts. When new belts are fitted, check the tension every 2-3 hours & adjust until the tension remains constant.
- The best tension for V-belt drives is the lowest tension at which the belts do not slip or ratchet under the highest load condition.
- Too much tension shortens belt & bearing life.
- Too little tension will affect the performance of your machine especially in respect of no-stress devices.
- Ensure that belt drives are kept free of any foreign materials.
- If a belt slips - tighten it!

(blank page)



PARTS LISTS

The following illustrations are for parts identification only. The removal or fitting of these parts may cause a hazard and should only be carried out by trained personnel.

	<i>Page No.</i>
BELT TENSIONER	33
CHASSIS - LIGHTBOARD	34
CHASSIS - 1	35
CHASSIS - 2	36
CHASSIS - 3	37
CONTROL BOX	38
CONTROL PANEL	39
DECALS	See pages 25 - 26
DISCHARGE	40
DRIVE TRAIN	41
ELECTRICAL LAYOUT	42
ELECTRICAL PANEL	43
ENGINE	44
ENGINE BAY	45
FUEL TANK	46
FUNNEL - TRAY	47
FUNNEL	48
HYDRAULIC HOSES	49
HYDRAULIC TANK	50
ROLLER BOX	51
ROLLER BOX GUARDS	52
ROLLER SLIDES	53
ROTOR	54
ROTOR HOUSING	55



ITEM NO.	PART NUMBER	DESCRIPTION	QTY.
1	P0002690M	Pulley SPB - 3 - 118 Tensioner	1
2	P0002692M	Bearing 6307	2
3	P0002691M	Belt Tensioner Shaft	1
4	P0002692M	Belt Tensioner Washer	1
5	BO313	M12x100 Hex Bolt Z/P Grade 8.8	1
6	C002-0627	M8x130 Hex Set Z/P Grade 8.8	1
7	0469MS	Block Pulley Tension Adjuster	1
8	WA712	Washer M8 C BZP	1
9	P0002693	Belt Tensioner Shim	4
10	NU476	Nut M8 1.75 BZP	1
11	P0002394	Profile Belt Tensioner	1

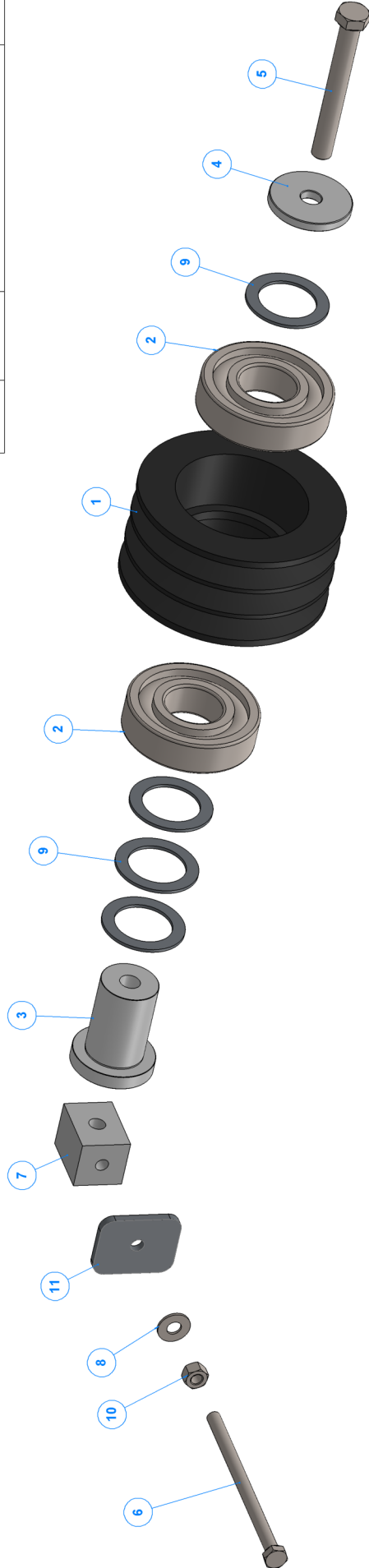



ITEM NO.	PART NUMBER	DESCRIPTION	QTY.
1	P0001878F	Bracket Light Board 1640 Length	1
2	P0001877F	Bracket Light Board Guard 362 Length	2
3	17895	Clip Number Plate	2
4	P0001405	N/S LED Cluster	1
5	P0001407	Lighting assembly LED	2
6	P0001406	O/S Led Cluster	1
7	WA711	Washer M8 A BZP	8
8	WA857	Washer M5 5.3 A BZP	4
9	18037	Set Screw M8 1.25 12 BZP	8
10	WA709	Washer M6 1.3 9 C BZP	2
11	NU142	Nut M6 P Nyloc	2
12	NU236	Nut M5 P Nyloc	4
13	RI066	Pop Rivit 5 x 6	6

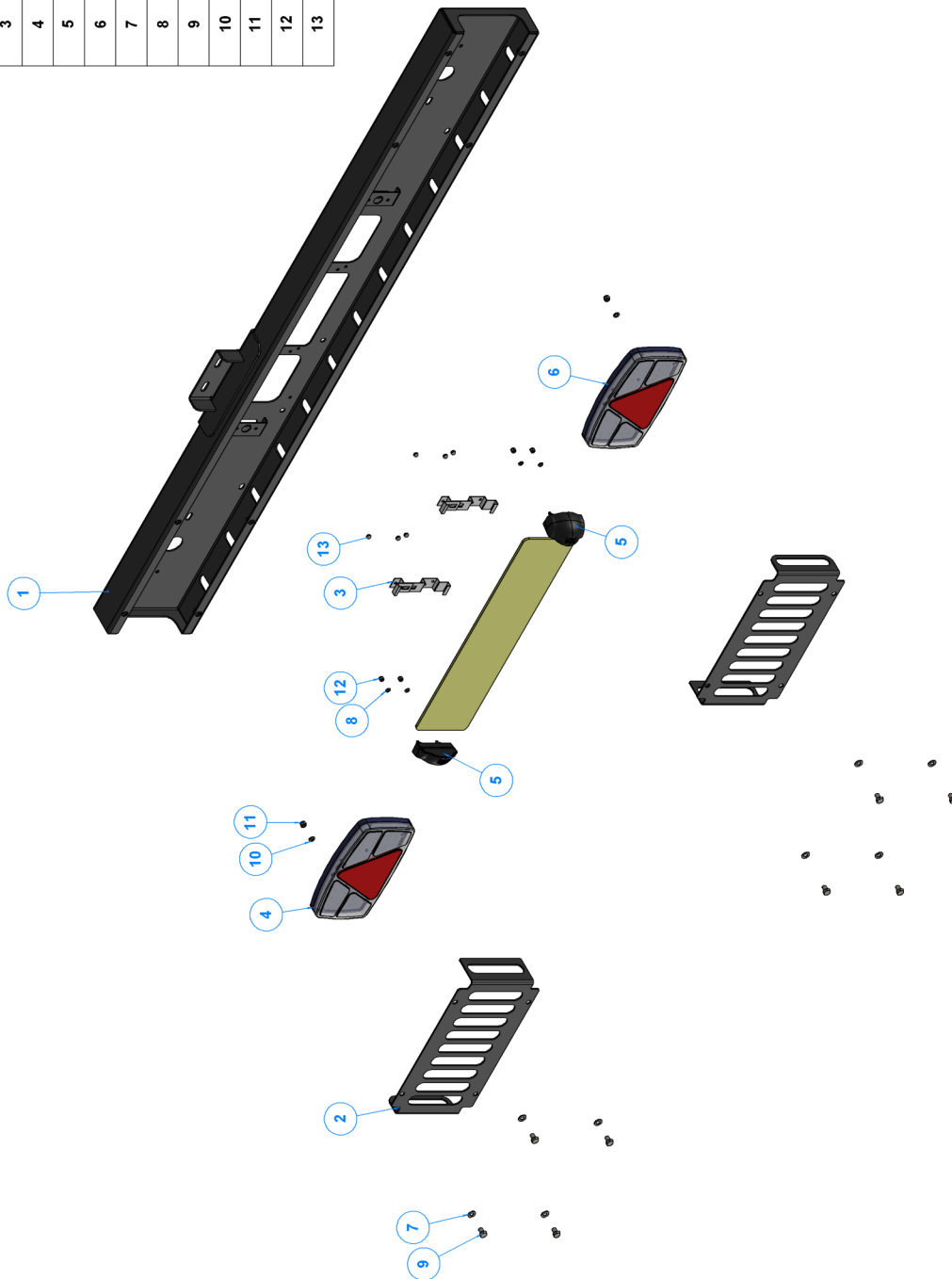



ITEM NO.	PART NUMBER	DESCRIPTION	Stage 1/QTY.
1	C008-0822	M12 x 90 HEX BOLT Z/P 8.8	4
2	WA701	Washer M10 A BZP	8
3	C031-0165	M12 TYPE P NYLOC NUT Z/P	8
4	WA709	Washer M6 C BZP	2
5	BO429	Set Screw M12 35 BZP	4
6	WA711	Washer M8 A BZP	4
7	C002-0709	M10 x 25 HEX SET Z/P 8.8	24
8	18102	Nut M5 0.8 Nyloc T	7
9	WA839	Washer M10 C BZP	20
10	C015-0607	M8 x 20 SKT CSK SET Z/P 10.9	4
11	C002-0607	M8 x 20 HEX SET Z/P 8.8	4
12	NU481	Nut M8 Nyloc T	8
13	C031-0121	M6 TYPE T NYLOC NUT Z/P	2
14	WA712	Washer M8 C BZP	8
15	C045-0108	4 x 12 Alu/Steel Rivet	6
16	C013-0308	M5 x 25 PAN POZI Z/P	3
17	WA704	Washer M12 C BZP	12
18	P00016556	Cast Tow Head Bradley DoubleLock	1
19	P0001586F	Beam Chassis 2612x165.75x155° NS Assy (Opp Hand of P0001587F)	1
20	P0001587F	Beam Chassis 2612x165.75x155° OS Assy (Opp Hand of P0001586F)	1
21	17478	Jockey Wheel	1
22	P0001646	Axle 1490 OHF - 930 CRS	1
23	P0001641F	Bracket Engine Rear Lower	1
24	P0001647F	Bracket Engine Front Lower	1
25	P0000863F	Bracket Chassis Light Socket	1
26	P0001835F	Bracket Tanks & Battery Support Side Assy	2
27	P0001831F	Bracket Tanks & Battery Support Bottom Assy	1
28	19600	Plate Machine Identification	1
29	19658	13 Pin Plug	1
30	TW280 TDHB Light Board		1
32	WA702	Washer M12 A BZP	4
33	C021-0102	M5 FORM A WASHER Z/P	3
34	C031-0124	M10 TYPE T NYLOC NUT Z/P	4
35	P0001404	Led Light Harness	1

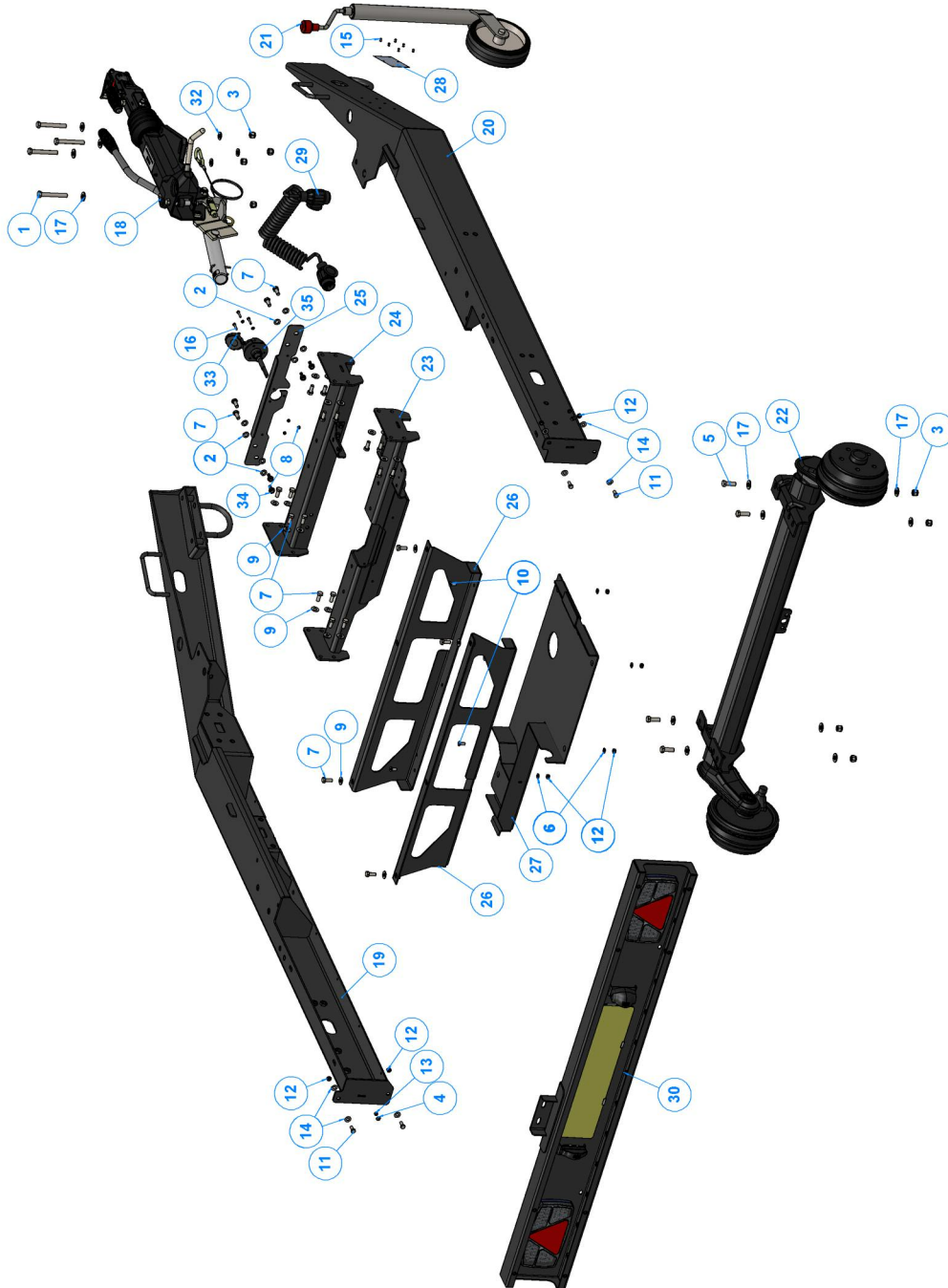



ITEM NO.	PART NUMBER	DESCRIPTION	QTY.
1	C008-0822	M12 x 90 HEX BOLT Z/P 8.8	2
2	C021-0107	M12 FORM A WASHER Z/P	4
3	C021-0106	M10 FORM A WASHER Z/P	16
4	C031-0164	M10 TYPE P NYLOC NUT Z/P	6
5	C031-0165	M12 TYPE P NYLOC NUT Z/P	2
6	C021-0123	M6 FORM C WASHER Z/P	2
7	C002-0407	M6 x 20 HEX SET Z/P 8.8	2
8	C021-0105	M8 FORM A WASHER Z/P	4
9	C002-0609	M8 x 25 HEX SET Z/P 8.8	2
10	C002-0710	M10 x 30 HEX SET Z/P 8.8	2
11	C002-0709	M10 x 25 HEX SET Z/P 8.8	4
12	C008-0714	M10 x 50 HEX BOLT Z/P 8.8	4
13	P0001635M	Square Boss AV Mount Engine	2
14	18522	AV Mount M12 CY 27 56	2
15	4315	Pre- Fuel Filter	1
16	18197	Spring Clip	1
17	0807	Fuel Pump	1
18	0085	Fuel Filter	1
19	AX017	Clamp Jack Stand	1
20	TW280 TDHB DCV & bracket	Cee Top Valve with Bracket	1
21	C045-0108	4 x 12 Alu/Steel Rivet	1
22	P0002458	Engine AV Mount 70	1
23	P0002798F	Prop Stand OD150mm	1
24	C002-0607	M8 x 20 HEX SET Z/P 8.8	2
25	C131-0134	Bracket Fuel Filter Bolted On	1

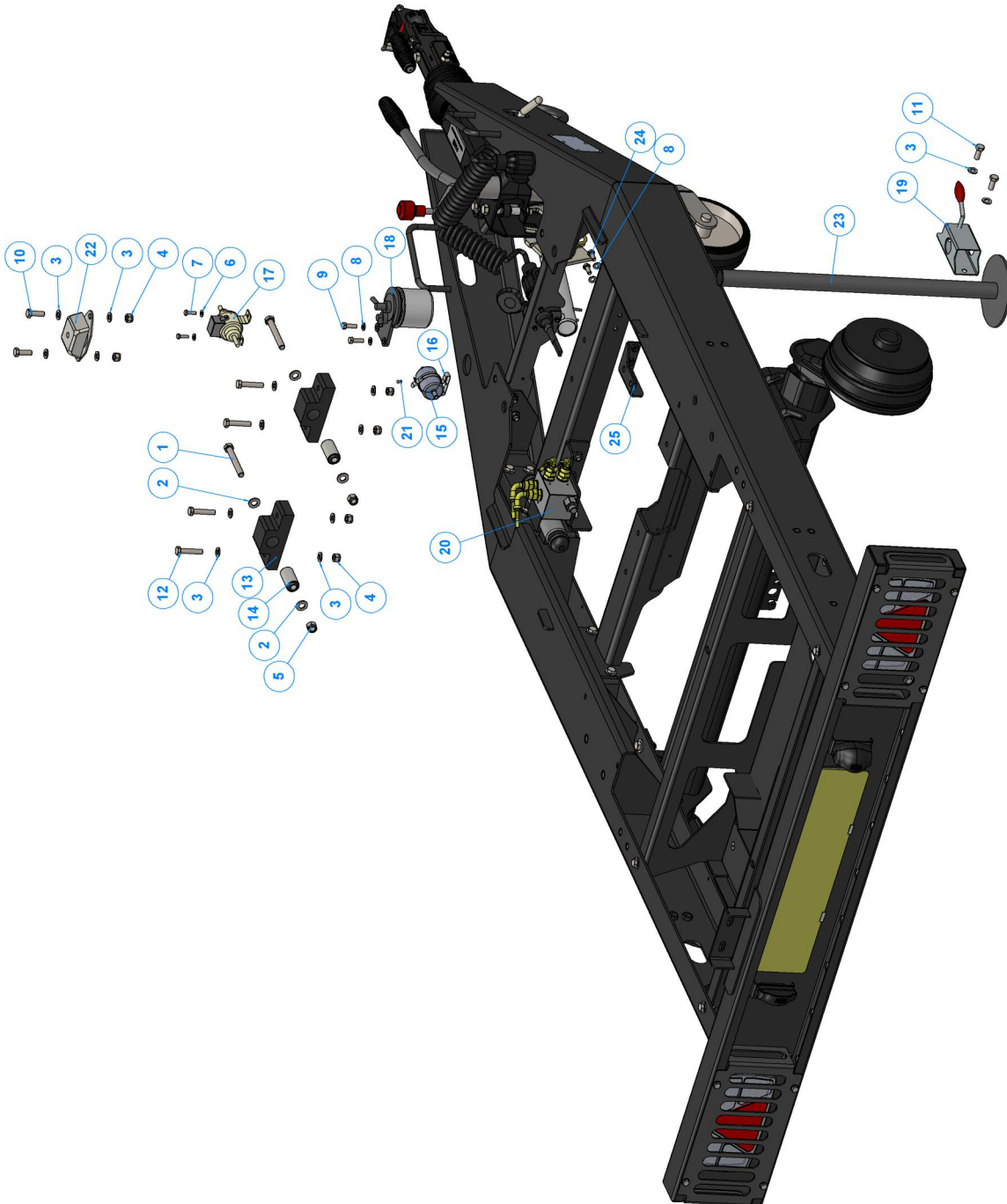



ITEM NO.	PART NUMBER	DESCRIPTION	QTY.
1	WA701	Washer M10 A BZP	6
2	Wheel bolt	Bolt M12 1.5 Wheel - Supp'd with axle	10
3	WA712	Washer M8 C BZP	14
4	C002-0609	M8 x 25 HEX SET Z/P 8.8	8
5	NU479	Nut M8 1.25 Nyloc P	14
6	WA839	Washer M10 C BZP	8
7	C002-0710	M10 x 30 HEX SET Z/P 8.8	8
8	WA714	M8x30 Mudguard washer Bzp.	8
9	C002-0709	M10 x 25 HEX SET Z/P 8.8	2
10	WA711	Washer M8 A BZP	6
11	C002-0607	M8 x 20 HEX SET Z/P 8.8	6
12	P0002385F	Bracket Mudguard Wheel 14 inches	2
13	P0001881	Mudguard Plastic EA-220	2
14	4210	Battery 12V	1
15	4074	Battery Terminals Kit	1
16	17776F	Battery Strap	1
17	C002-0607	M8 x 20 HEX SET Z/P 8.8	2
18	WA711	Washer M8 A BZP	4
19	NU479	Nut M8 1.25 Nyloc P	2
20	C013-0307	M5 x 20 PAN POZI Z/P	2
21	C021-0102	M5 FORM A WASHER Z/P	2
22	NU236	Nut M5 P Nyloc	2
23	P0001250F	Bracket Reflector Mudguard NS Opposite of P0001251F	1
24	18922	Reflector clear round front	1
25	18923	Reflector amber round side	1
26	18919	Support for Light Reflector	1
27	C013-0307	M5 x 20 PAN POZI Z/P	2
28	C021-0102	M5 FORM A WASHER Z/P	2
29	NU236	Nut M5 P Nyloc	2
30	C002-0607	M8 x 20 HEX SET Z/P 8.8	2
31	WA711	Washer M8 A BZP	4
32	NU479	Nut M8 1.25 Nyloc P	2
33	P0001251F	Bracket Reflector Mudguard OS Opposite of P0001250F	1
34	18923	Reflector amber round side	1
35	18922	Reflector clear round front	1
36	18919	Support for Light Reflector	1
37	P0002231F	Bracket CeeTop Valve	1
38	19369	19369 Directional Control Valve No Filter	1
39	BO372	Socket Head Cap M8 1.25 20	2
40	WA712	Washer M8 C BZP	2
41	1932	Wheel 195 70R 14inches 96N	2





ITEM NO.	PART NUMBER	DESCRIPTION	Manual Page/Qty
1	17802F	Control Box Cover	1
2	17805F	Switch Mounting Plate Control Box	1
3	18000	AV Mount M6 MF 20 14.5	4
4	17803F	Finger Plate	1
5	17803F	Finger Plate	1
6	2834	Av Mount VE Type	2
7	17927	Limit Switch	2
8	2804	Bush M10 Top Hat	4
9	C021-0101	M4 FORM A WASHER Z/P	2
10	C035-0102	M4 TYPE P NYLOC NUT Z/P	6
11	C013-0210	M4 x 35 PAN POZI Z/P	4
12	WA839	Washer M10 C BZP	2
13	C031-0164	M10 TYPE P NYLOC NUT Z/P	1
14	NU142	Nut M6 P Nylloc	4
15	C045-0107	4.8 x 12 St St/Sl St Rivet	4
16	C021-0121	M4 FORM C WASHER Z/P	4
17	C008-0730	M10 x 160 HEX BOLT Z/P 8.8	1

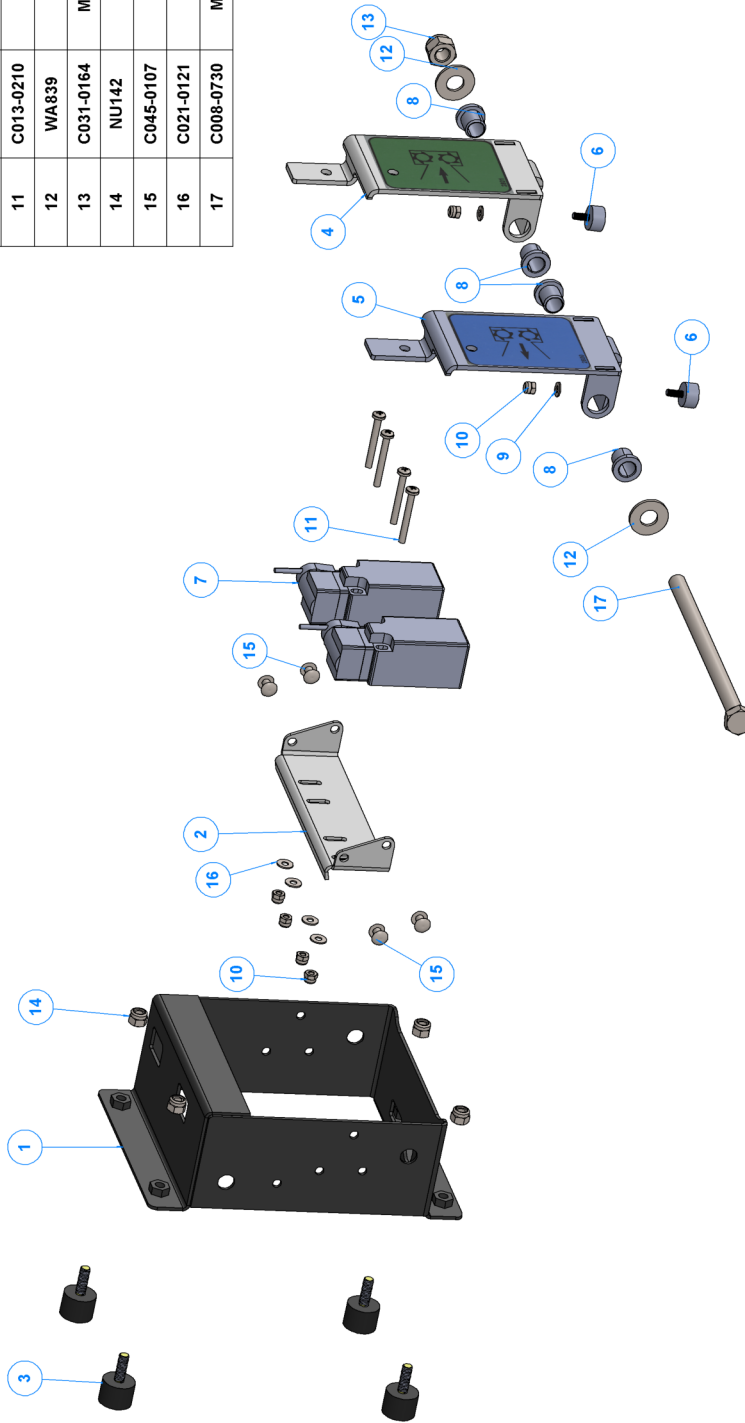



ITEM NO.	PART NUMBER	DESCRIPTION	QTY.
1	WA709	Washer M6 C BZP	4
2	BO438	Pan Head Pozi M6 1.0 16 BZP	4
3	P0001892	Profile Control Panel With 12 Volt Cut-Out	1
4	0327	Hours Counter	1
5	Kubota Ignition Switch	Supp'd with engine	1
6	1470	Rubber Protector	1
7	1757	Amber LED	1
8	P0002041	Durite 12 Volt Socket 0-601-07	1

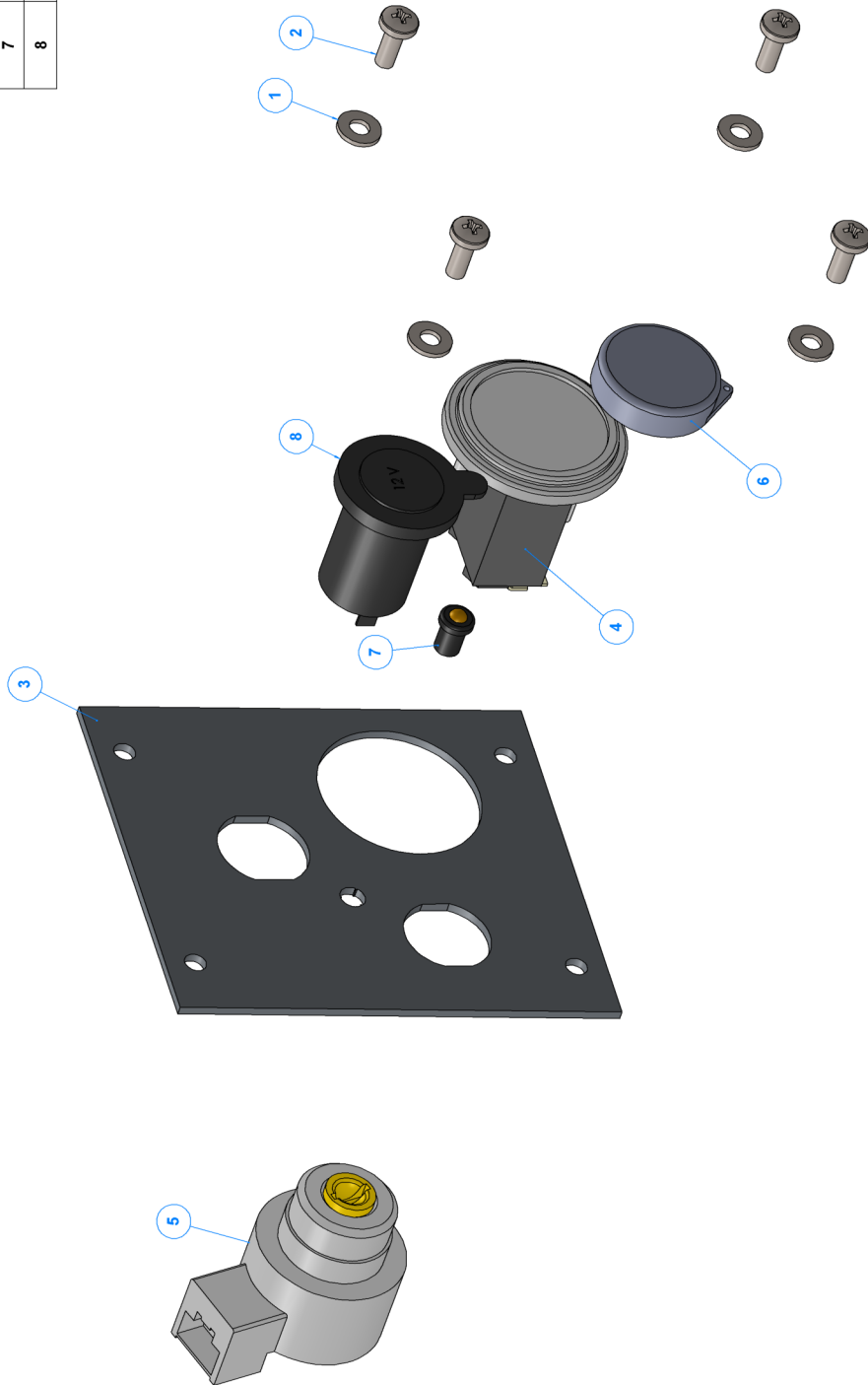



ITEM NO.	PART NUMBER	DESCRIPTION	QTY.
1	WA1354	Washer M16 C BZP	1
2	BO434	Bolt M16/70	1
3	WA702	Washer M12 A BZP	2
4	18190	Washer M24 B BZP	1
5	NU644	Nut M12 P Nyloc	2
6	NU1511	Nut M16 P Nyloc	2
7	4131	Roll Pin	1
8	P0001147	Discharge Tube Assy	1
9	P0001411	Bucket Discharge Tube Assy	1
10	1649M	Tommy Bar	1
11	4109M	M16 Clamp Nut	1
12	2837M	Clamp Discharge	1
13	BO430	Bolt M12/35 Cup Square Bzp	1
14	19282	M12/30 Cup Square	1
15	1507	Socket Set Screw M16x1.5x60	1

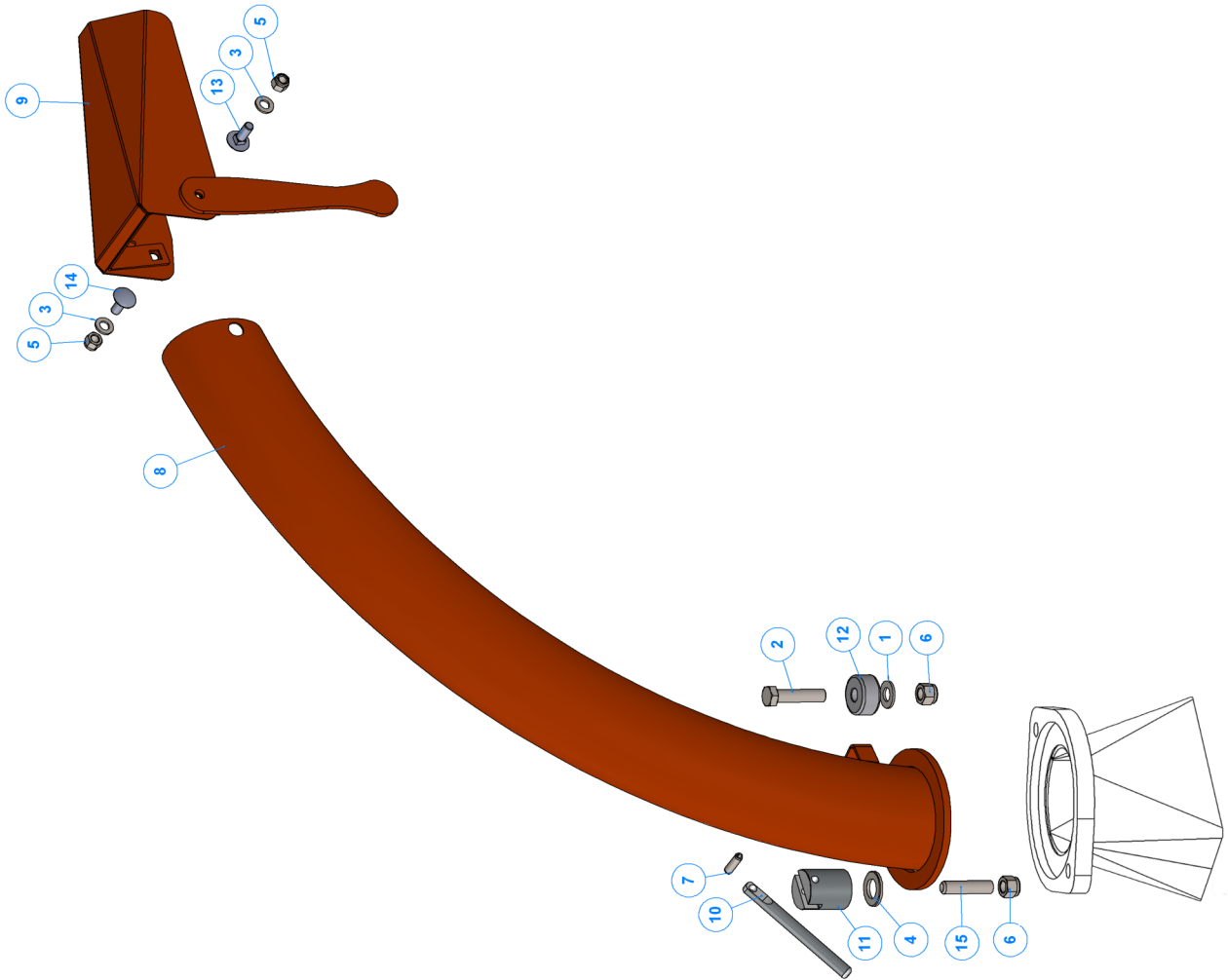



ITEM NO.	PART NUMBER	DESCRIPTION	QTY.
1	P0001655	Pulley SPB 3 315	1
2	P0001029M	Pulley SPB 3 175 Z	1
3	P0001826	Taperlock Bush 3020 45	1
4	P0002215	Belt SPB 1600	3
5	P0002690M	Pulley SPB - 3 - 118 Tensioner	1
6	P0002216	Key 14x9x50	1

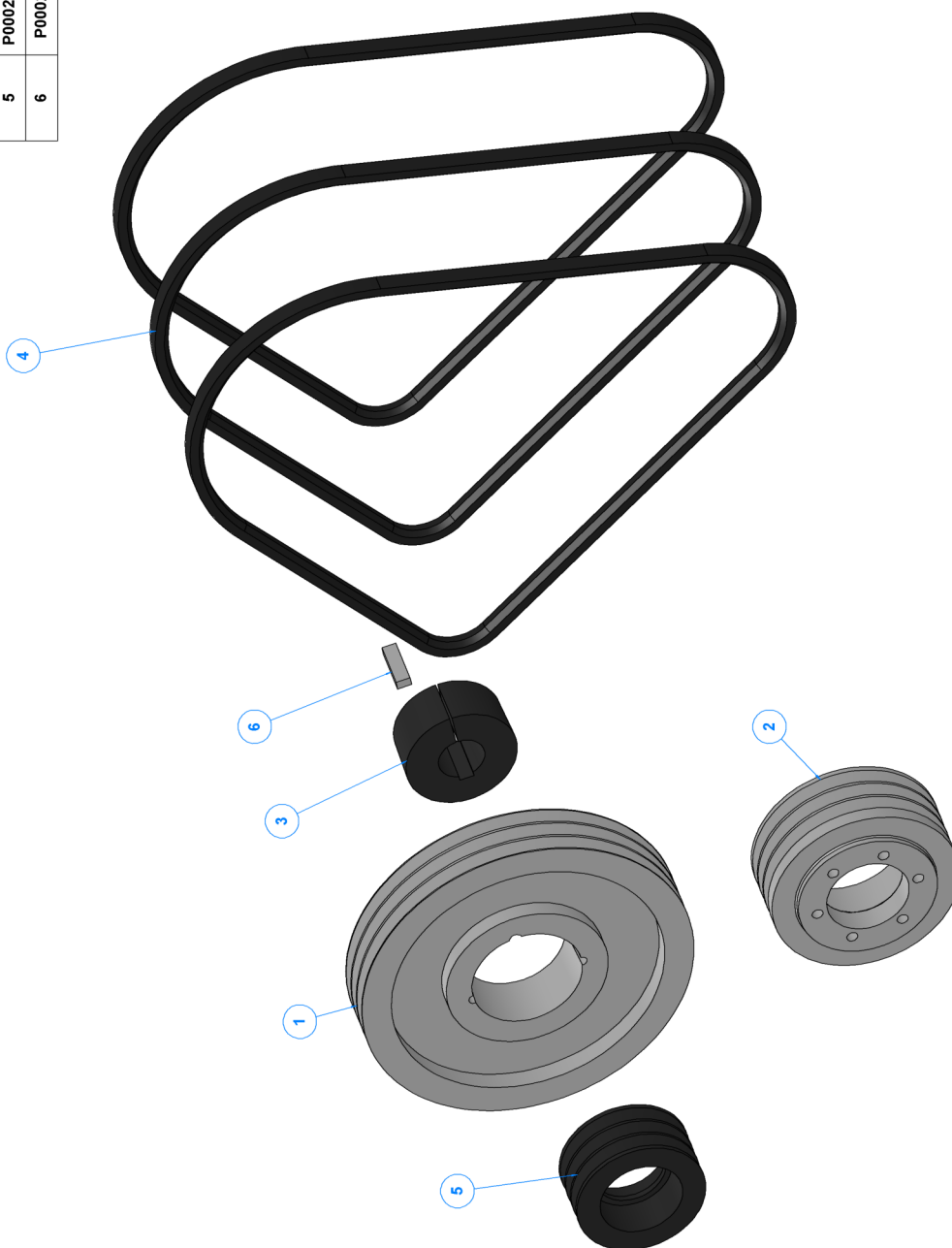

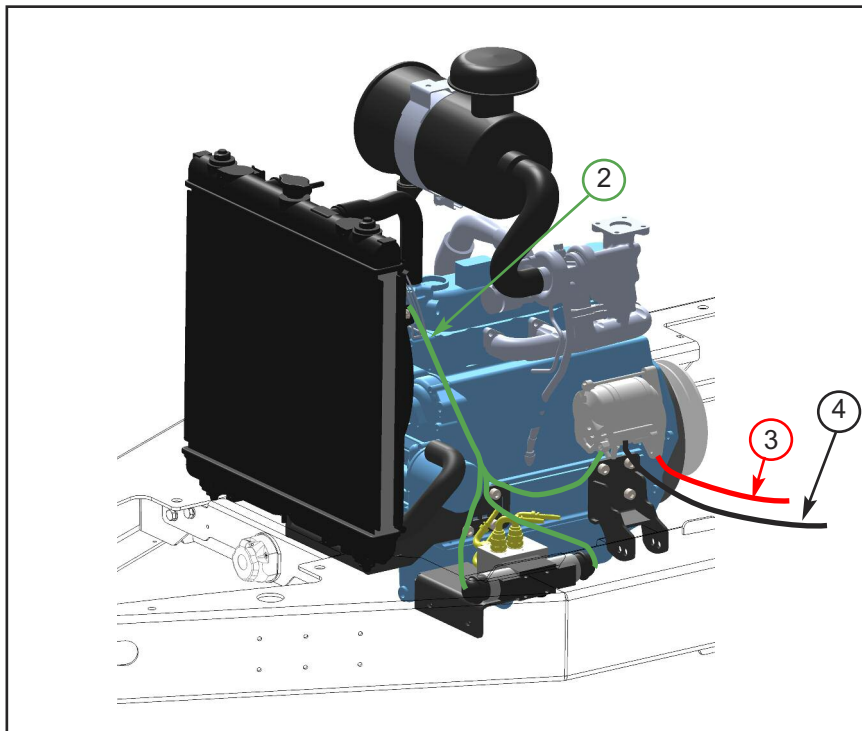
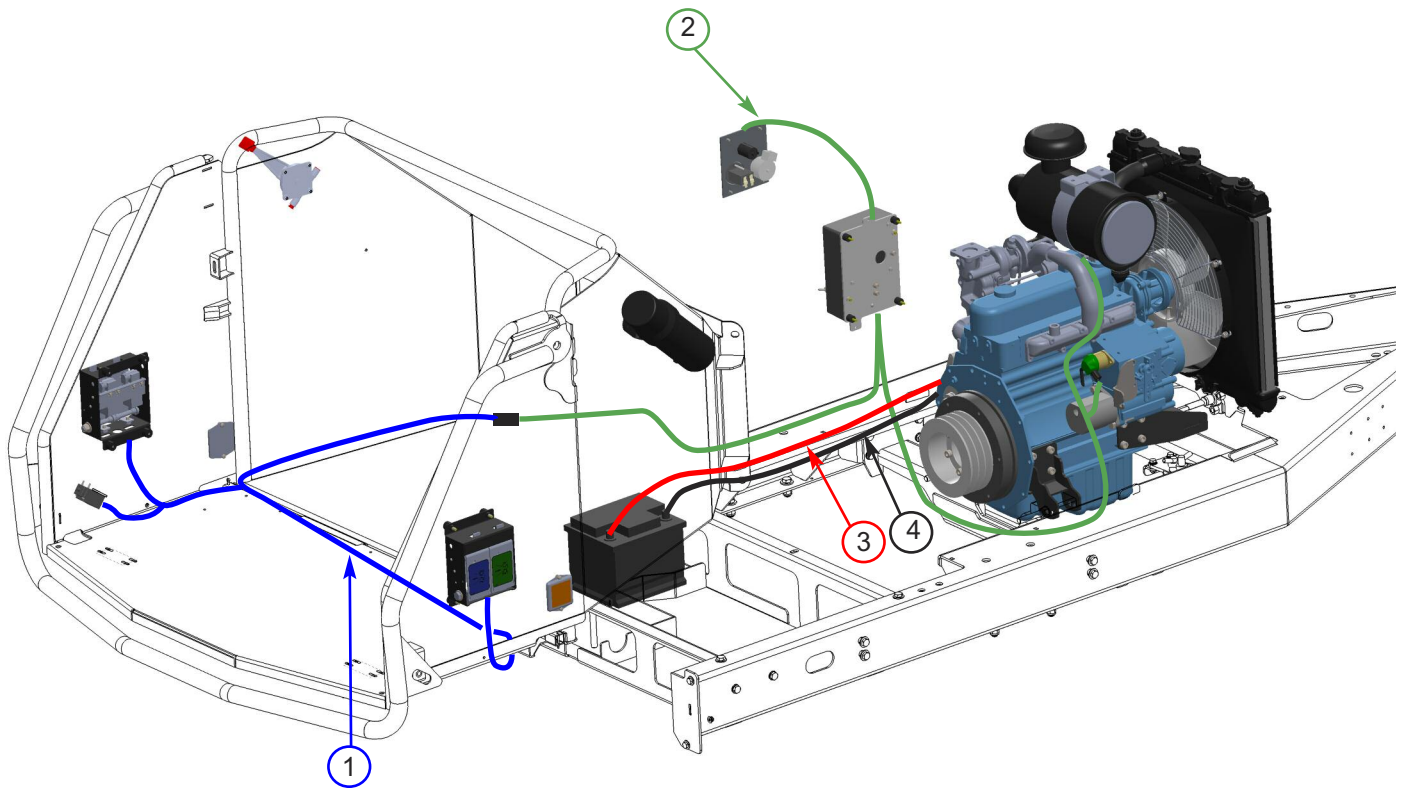

ITEM	PART NO	DESCRIPTION	QTY	ITEM	PART NO	DESCRIPTION	QTY
1	17809	Funnel Loom	1	3	P2131	+VE Battery Cable	1
2	P2741	Main Engine Loom	1	4	P2132	-VE Battery Cable	1



ITEM NO.	PART NUMBER	DESCRIPTION	QTY.
1	18106	Washer M6 Spring BZP	2
2	18107	M6 Wing Nut	2
3	WA857	Washer M5 5.3 A BZP	8
4	18104	Pan Head Pozi M5 0.8 12 BZP	4
5	1151	Countersunk Pop Rivet	1
6	NU391	Nut M6 1.0 Nyloc T	2
7	BO438	Pan Head Pozi M6 1.0 16 BZP	2
8	3024	Washer M5 Spring BZP	4
9	18291	Nut M5 0.8 Plain BZP	4
10	WA709	Washer M6 C BZP	4
11	P000856F	Plate H-Box Assy	1
12	4033	AV Mount M5 x 13mm Green Spot	4
13	18398F	Bracket H-Box	2
14	18405	H-Box	1
15	EP2725	Stand Off Nylon M6 62mm	2
16	GD1930	Cover Electrical General Short	1
17	P0001445_	Supp'd with loom	2
18	Fuse	Supp'd with loom	1

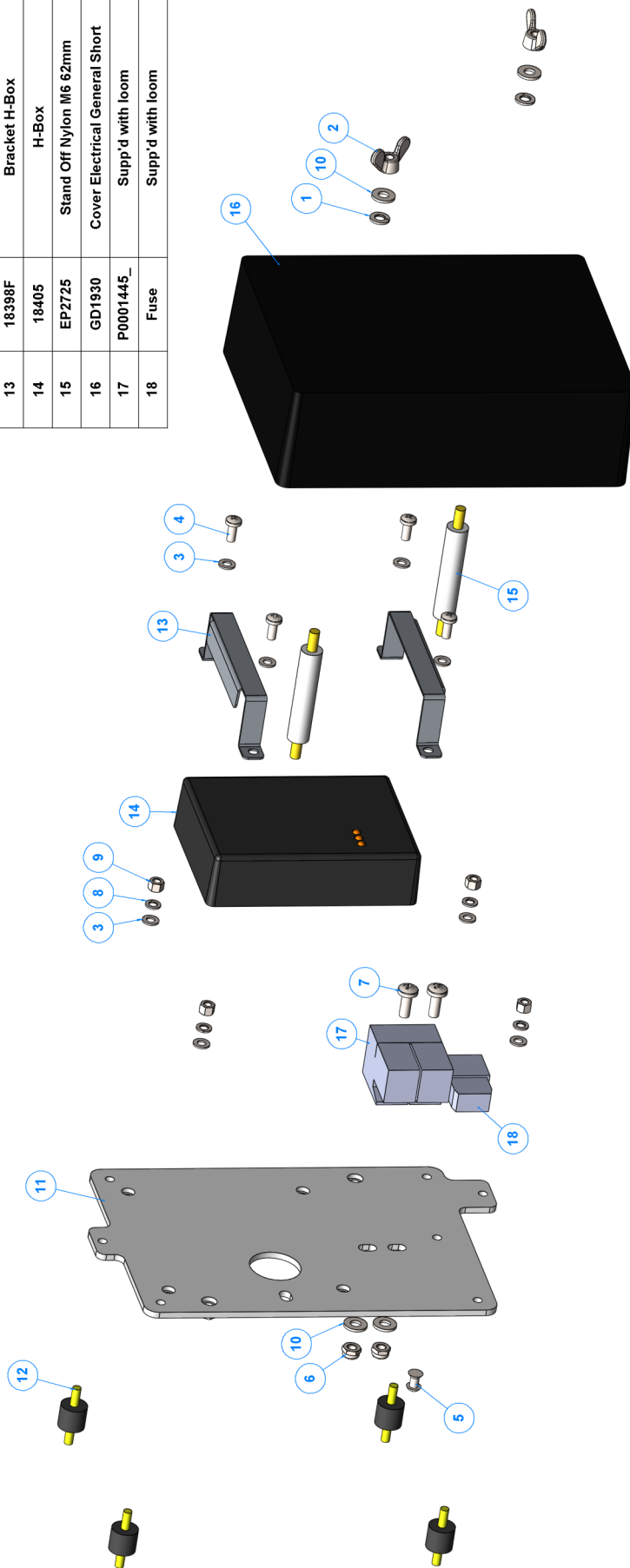



ITEM NO.	PART NUMBER	DESCRIPTION	QTY.
1	WA711	Washer M8 A BZP	3
2	NU0479	Nut M8 1.25 Nyloc P	1
3	BO0346	Set Screw M8 1.25 20 BZP	1
4	BO352	Set Screw M8 1.25 40 BZP	1
5	4313	Kubota 1505 Turbo Engine	1
6	0095	Oil Filter 1505	1
7	4319	Radiator Kit (1G666-72001)	1
8	4335	Radiator Fan Guard	1
9	P0001029M	Pulley SPB 3 175	1
10	MO1660	Pump Hydraulic Engine Driven 6.61Cc	1
11	P0000756	Bracket Throttle Cable	1
12	4316	Air Filter Housing (1661711002_M)	1
13	18345	Air Filter	1
14	P0001662F	Bracket Engine Front Upper	1
15	P0001636F	Bracket Engine Rear Upper	2
16	P0000369	Socket Head Cap M10 1.25 20	16
17	4054	Socket Head Cap M10 1.25 35	6
18	WA709	Washer M6 C BZP	8
19	NU392	Nut M6 1 Plain BZP	4
20	18106	Washer M6 Spring BZP	4
21	BO1236	Set Screw M6 20 BZP	4
22	WA702	Washer M12 A BZP	1
23	BO321	Set Screw M12 30 BZP	1

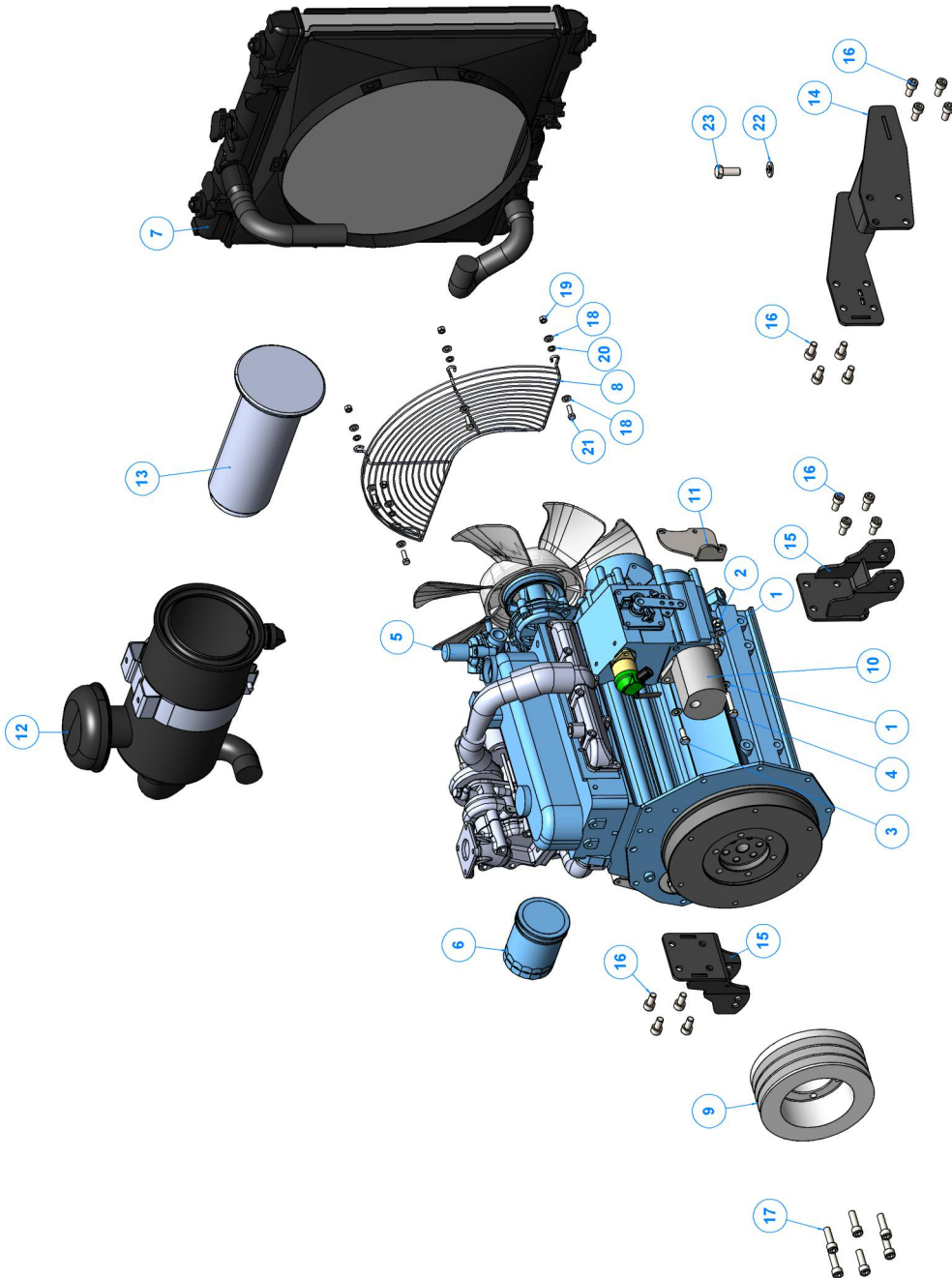



ITEM NO.	PART NUMBER	DESCRIPTION	QTY.
1	4343	M6 x 24 Mudguard Washer	8
2	TW 280TDHB Top Bonnet		1
3	P0002365F	Top Bonnet Angular 9°	1
4	4320	Reserve Tank Radiator	1
5	P0002525F	Access Cover Tapered Assy	1
6	18327FB	S/Sl Exhaust Muffler. (Road Tow)	1
7	18456F	Flexible Exhaust Adapter	1
8	P0002933F	Guard Air Intake	1
9	17988	Gasket Muffler	3
10	WA711	Washer M8 A BZP	2
11	C002-0607	M8 x 20 HEX SET Z/P 8.8	2
12	C021-0102	M5 FORM A WASHER Z/P	5
13	C013-0305	M5 x 16 PAN POZI Z/P	5
14	C045-0107	4.8 x 12 St Sl/St Sl Rivet	2
15	C137-0102	Access Cover Tapered Catch	1
16	TW 280TDHB Front Guard & Grill		1
17	P0002517F	Guard Front Angular Assy	1
18	P0002380F	Bracket Front Grill Assy	1
19	0235	Catch Assy	1
20	C005-0305	M5 x 16 SKT CAP SET Z/P 12.9	2
21	C021-0102	M5 FORM A WASHER Z/P	2
22	NU236	Nut M5 P Nyloc	2
23	P0002521F	Bracket Side Panel & Front Guard Stop	2
24	P0001740	Panel Side Plastic Sharp Design	2
25	P0002600	Profile E Stop	1
26	2627	Emergency Stop Switch	1
27	P0002796	Plastic Strip Radiator	2
28	WA711	Washer M8 A BZP	10
29	C002-0607	M8 x 20 HEX SET Z/P 8.8	2
30	WA839	Washer M10 C BZP	8
31	C002-0709	M10 x 25 HEX SET Z/P 8.8	4
32	WA702	Washer M12 A BZP	2
33	C002-0809	M12 x 25 HEX SET Z/P 8.8	2
34	C002-0612	M8 x 40 HEX SET Z/P 8.8	4
35	C031-0124	M10 TYPE T NYLOC NUT Z/P	2
36	C013-0303	M5 x 12 PAN POZI Z/P	4
37	C030-0123	M8 HEX NUT - ZP - GRADE 10	4
38	C002-0609	M8 x 25 HEX SET Z/P 8.8	4
39	C023-0105	M8 SPRING WASHER - ZP	8
40	C031-0121	M6 TYPE T NYLOC NUT Z/P	8
41	C021-0122	M5 FORM C WASHER Z/P	6
42	WA709	Washer M6 C BZP	8
43	C002-0405	M6 x 16 HEX SET Z/P 8.8	8
44	BO878	Bolt M10 20 BZP	2

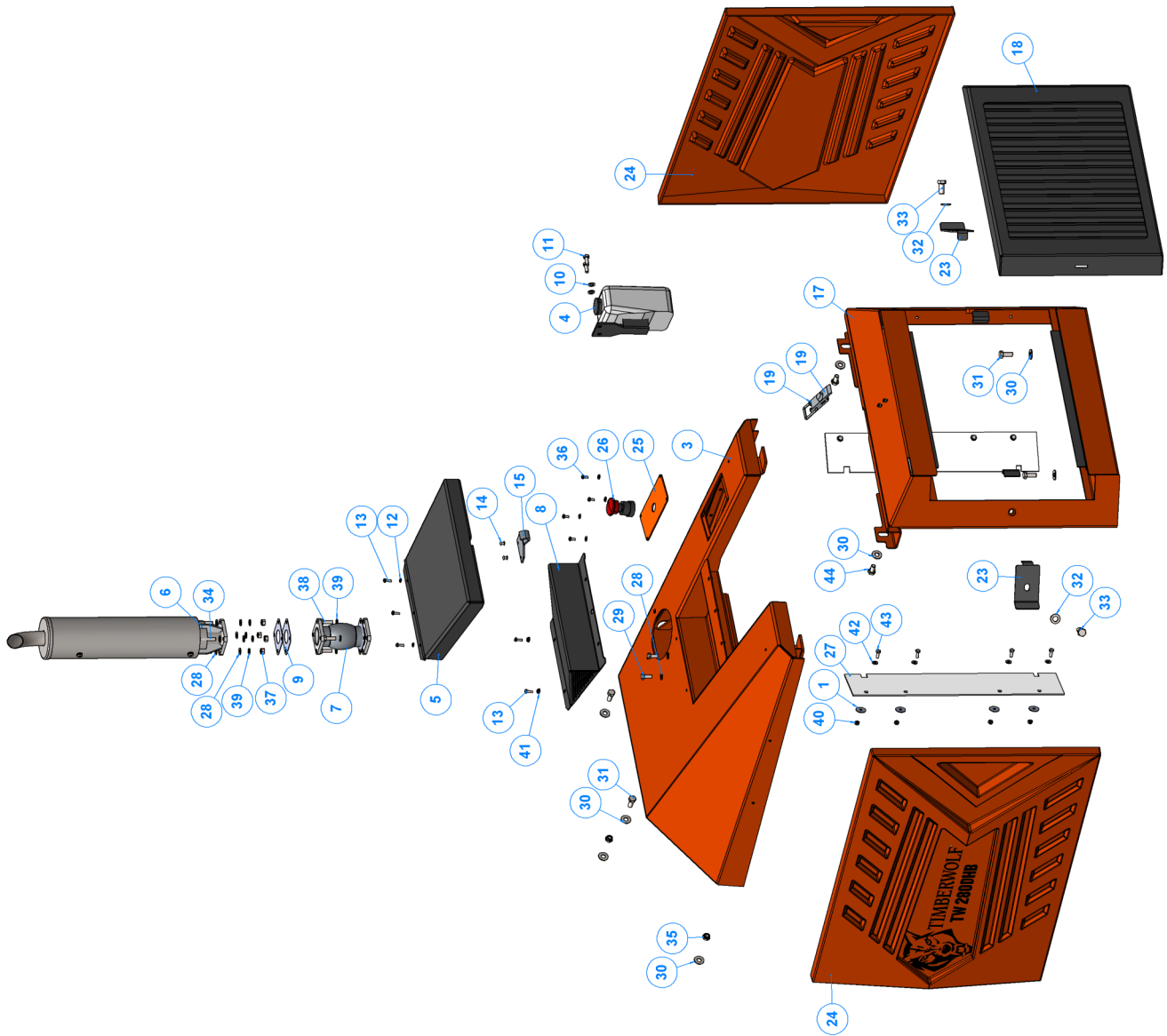



ITEM NO.	PART NUMBER	DESCRIPTION	QTY.
1	18568	18568 Reducer Bush (Dowty) 3-4M x 1-4F	1
2	HY396	Washer Dowty 3/8"	1
3	HY211	3/8" Drain Plug	1
4	HY152	Washer Dowty 3/4"	1
5	HY395	1/4" Dowty Washer	4
6	17998	Quarter Inch Banjo Fitting No Bolt	1
7	4059	Quarter Inch Banjo Bolt	2
8	P0001710	Tank Fuel 38 Litre	1
9	P0001815	Threaded Filler Neck OD65	1
10	P0001817	P0001817 Fuel Tank Cap	1
11	P0001816	SS Strain for Tanks with Reinforcement Ring	1
12	C070-0104	Quarter Inch Banjo Fitting	1
13	C172-0101	Threaded Fuel Pick Up 280mm	1

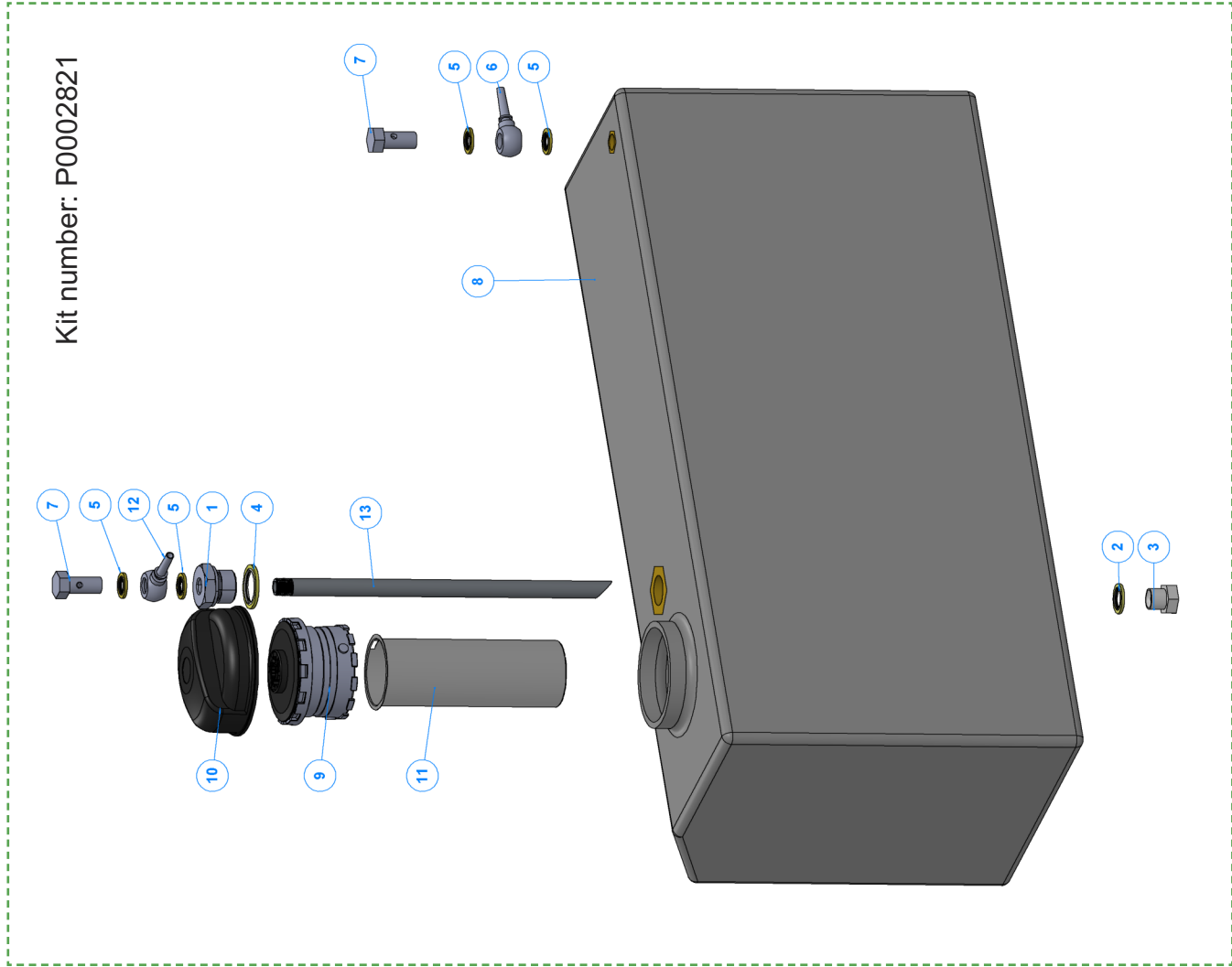



ITEM NO.	PART NUMBER	DESCRIPTION	QTY.
1	TW 280TDHB Tray Assy		1
2	C021-0127	M12 FORM C WASHER ZIP	4
3	C002-0811	M12 x 35 HEX SET ZIP 8.8	2
4	C031-0125	M12 TYPE T NYLOC NUT ZIP	2
5	C013-0209	M4 x 30 PAN POZI ZIP	2
6	C021-0125	M8 FORM C WASHER ZIP	1
7	C031-0163	M8 TYPE P NYLOC NUT ZIP	1
8	C021-0123	M6 FORM C WASHER ZIP	10
9	C002-0405	M6 x 16 HEX SET ZIP 8.8	10
10	C002-0713	M10 x 45 HEX SET ZIP 8.8	2
11	C031-0164	M10 TYPE P NYLOC NUT ZIP	2
12	C031-0121	M6 TYPE T NYLOC NUT ZIP	8
13	P0003501F	Feed Tray	1
14	1598F	Control Bar Assy High Funnel	1
15	1599	Bearing Washer	2
16	1605M	Stainless Spacer	2
17	1603	Spring Die (Stop Bar)	2
18	1601	Nylon Piston OD20 - 45mm	2
19	2923F	Hinge Pin	1
20	2727F	Bracket Actuator Control Bar Assy	1
21	EL1348	Switch Limit (Metal Plunger)	1
22	CO178	Buffer Rubber	1
23	WA4344	Washer M10 29.75 Penny BZP	2
24	1337_	Rubber Cap	2
25	2493	Rubber Cap	2
26	18924	Square Reflector	2
27	TW280 TDHB Control Box		2
28	1591	Spacer 10x15x20	2
29	2986	Spring Bolt	2
30	C015-0401	C'SUNK SCREW M6x8 ZP GRADE 10.9	8
31	C045-0107	4.8 x 12 ST/ST/ST Rivet	4
32	1276	Split Pin	2

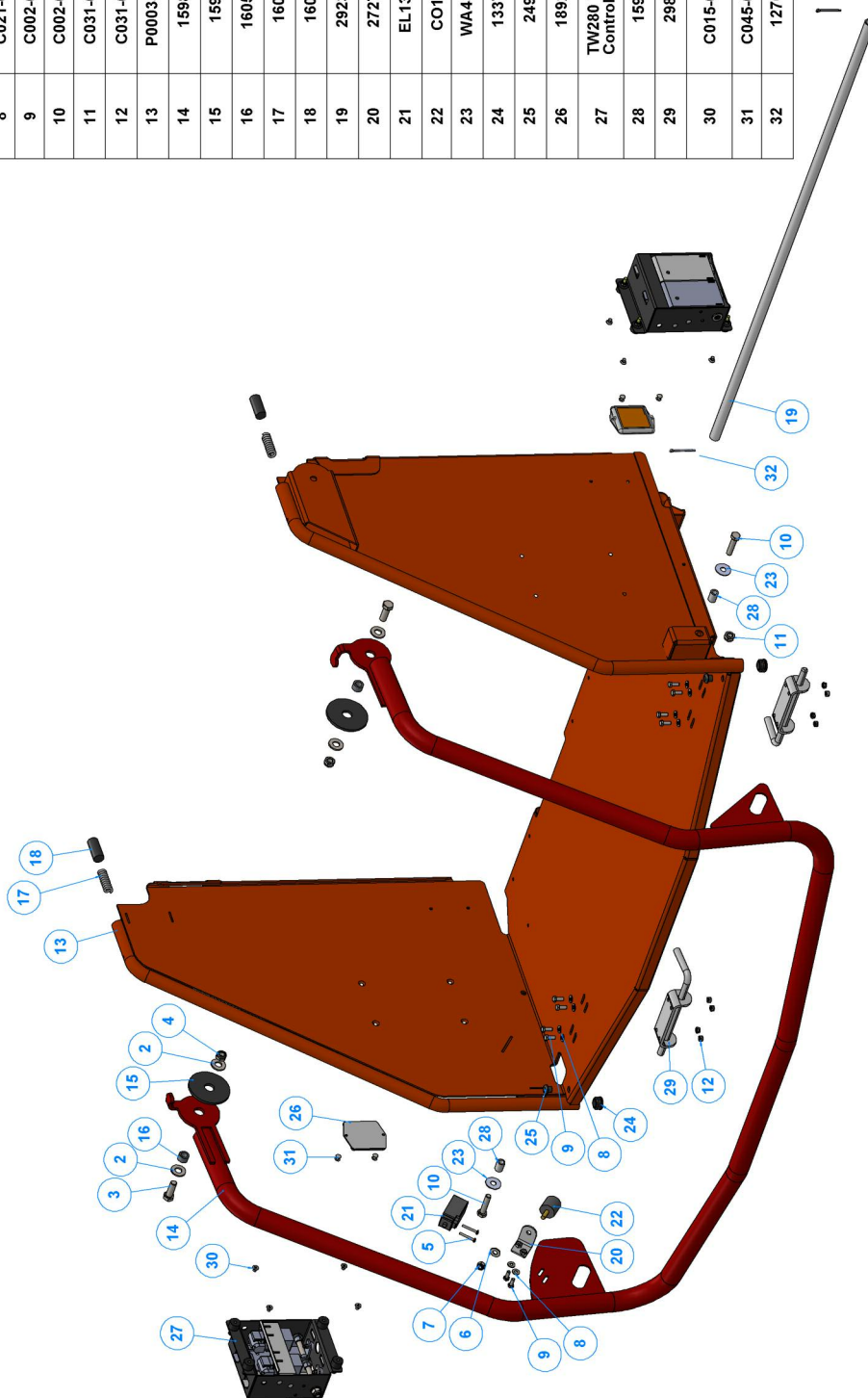



ITEM NO.	PART NUMBER	DESCRIPTION	QTY.
1	WA704	Washer M12 C BZP	15
2	BO429	Set Screw M12 35 BZP	4
3	C031-0165	M12 TYPE P NYLOC NUT Z/P	4
4	C015-0614	M8 x 50 SKT CSK SET Z/P 10.9	1
5	WA712	Washer M8 C BZP	11
6	NU481	Nut M8 Nyloc T	4
7	C013-0305	M5 x 16 PAN POZI Z/P	4
8	C021-0102	M5 FORM A WASHER Z/P	4
9	18102	Nut M5 0.8 Nyloc T	4
10	C031-0164	M10 TYPE P NYLOC NUT Z/P	2
11	C031-0125	M12 TYPE T NYLOC NUT Z/P	7
12	BO320	M12 x 25 CUP SQ BOLT Z/P	4
13	C002-0609	M8 x 25 HEX SET Z/P 8.8	2
14	NU479	Nut M8 1.25 Nyloc P	2
15	C002-0710	M10 x 30 HEX SET Z/P 8.8	2
16	P0001784F	Bracket Funnel 280 x 203 Support	1
17	P0000144	Operator's Manual Canister	1
18	P0003532	Throttle	1
19	1933F	Spare Wheel Bracket	1
20	4206	Nylon Bush	1
21	1932	Wheel 195 70R 14inches 96N	1
22	IN654	Grommet Hole OD19.05mm	4
23	P0000758	Profile Bracket Spare Wheel Lock	1
24	C011-0607	M8 x 20 SKT Button Set Z/P 10.9	3
25	WA839	Washer M10 C BZP	4
26	P0001566F	Funnel 280 x 203	1

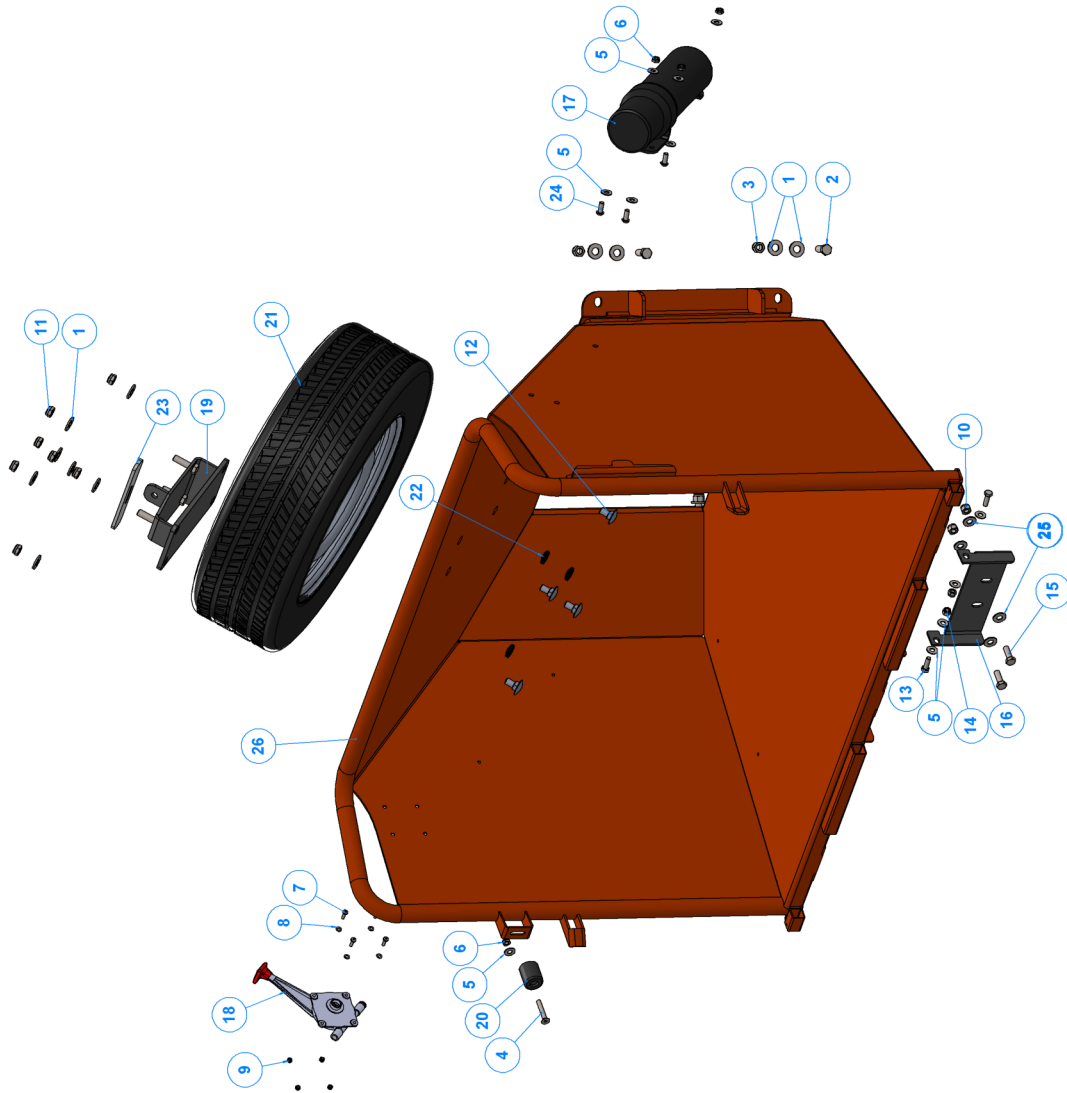



ITEM NO.	PART NUMBER	DESCRIPTION	QTY.
1	2982B	Parker Motor	2
2	HY161	Adaptor Mm 3/8 - 3/8	5
3	HY396	Washer Dowty 38	6
4	HY026	Adapter 3/8 - 1/2	4
5	HY398	Washer Dowty 12	4
6	MO1660	Pump Hydraulic Engine Driven 6.61Cc	1
7	19369	19369 Directional Control Valve No Filter	1
8	1583	Adaptor 1/2" - 3/4" BSP	1
9	HY398	Washer Dowty 12	1
10	HY152	Washer Dowty 3/4"	2
11	HY225	Adaptor 3/8" - 3/4" BSP	1
12	HY1766	Adaptor 3/4" - 3/4" BSP	1
13	P3507	3/4" Hose - Tank to Pump	1
14	P2791	3/8" Hose - Parker Motor to Parker Motor	1
15	P3506	3/8" Hose - Bank to Tank Return	1
16	P2790	3/8" Hose - DCV to Lower Parker Motor	1
17	P2792	3/8" Hose - DCV to Upper Parker Motor	1
18	P3505	3/8" Hose - Pump to DCV	1

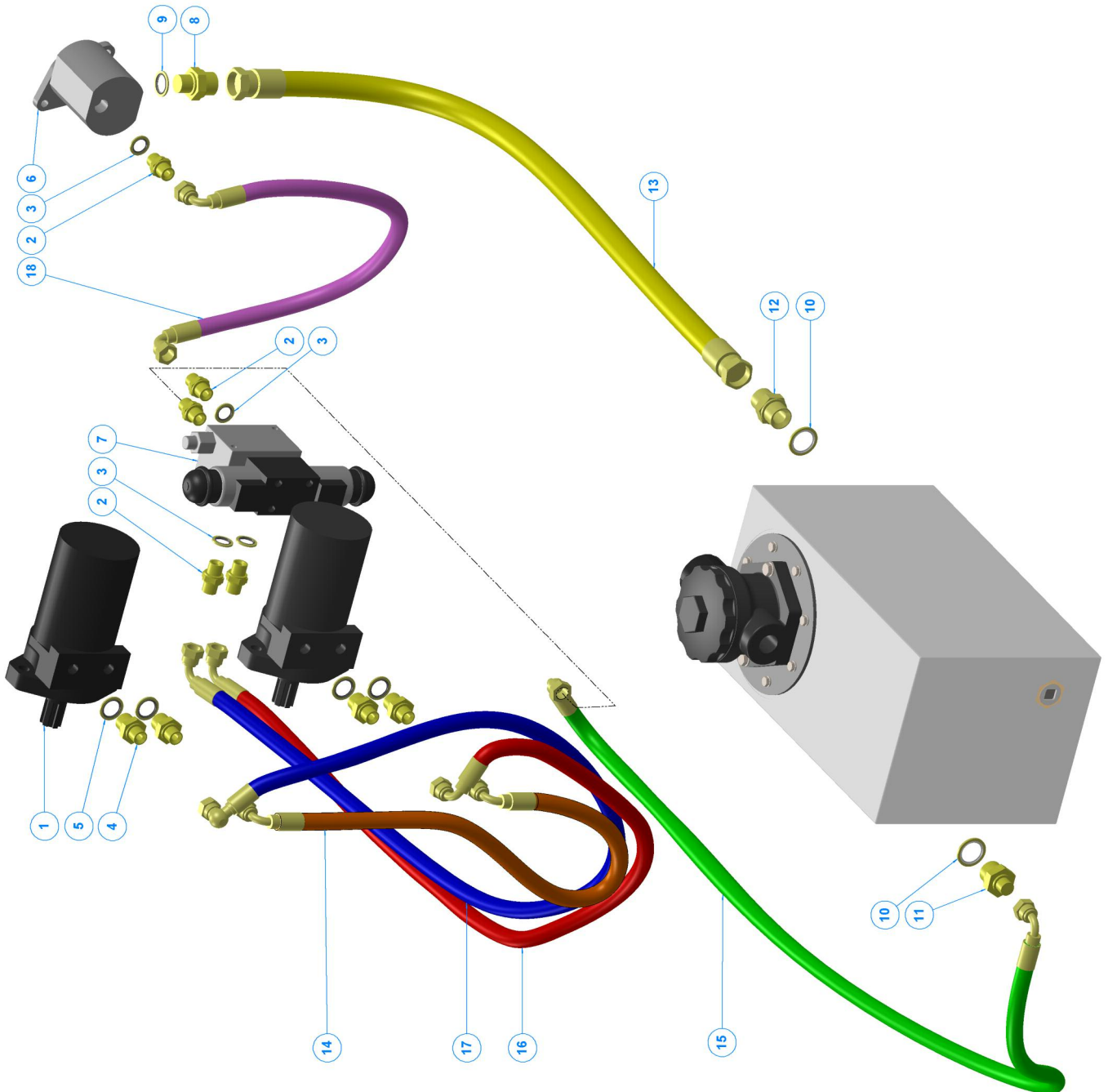

HYDRAULIC TANK



TIMBERWOLF
TW 280TDHB

50

ITEM NO.	PART NUMBER	DESCRIPTION	QTY.
1	BO1658	Set Screw M6 12 BZP	8
2	WA709	Washer M6 C BZP	8
3	WA711	Washer M8 A BZP	2
4	BO351	Set Screw M8 30 BZP	2
5	1703	Hydraulic Oil Tank	1
6	HY396	Washer Dowty 38	1
7	HY211	3/8" Drain Plug	1
8	1702F	Tank Top Adapter Plate	1
9	HY1434F Gasket	Tank Top Filter Gasket	1
10	HY1434	In Tank Filter	1
11	HY152	Washer Dowty 3/4"	2
12	HY225	Adaptor 3/8" - 3/4" BSP	1
13	HY1766	Adaptor 3/4" - 3/4" BSP	1
14	4219	3/4" Tapered Blanking Plug	1

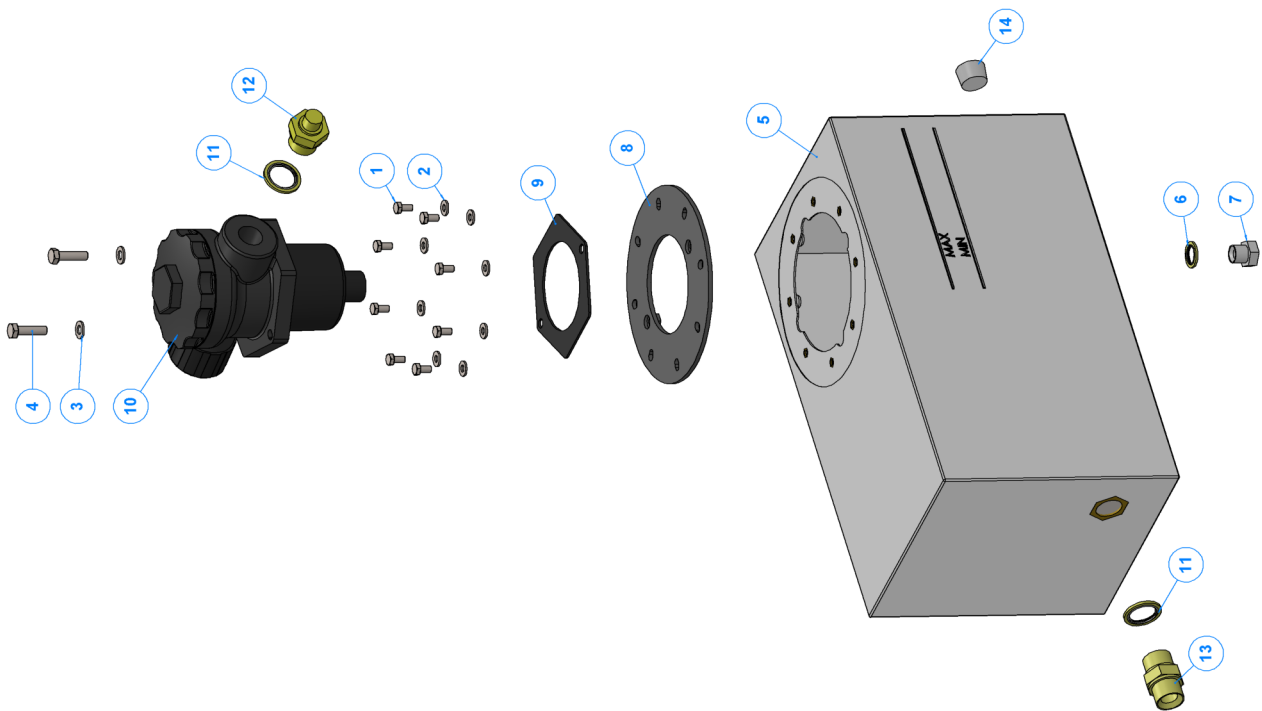



ITEM NO.	PART NUMBER	DESCRIPTION	Default/QTTY.
1	19730	Bolt M12 1.75 35 BZP	2
2	4345	Nut M10 P Nyloc	4
3	18474	Fitting Grease Point Right Angle	1
4	WA839	Washer M10 C BZP	8
5	C024-0107	M12 CSK HEAVY WASHER ACCEPTS M12/30CSK	4
6	WA702	Washer M12 A BZP	4
7	P0000014	Screw M10 1.5 30 CSK	4
8	BO348	Screw M8 20 Csk Socket Plain	2
9	NU052	Nut M10 Nyloc T	4
10	P0000993	Profile Roller Box Hatch Switch Mount	1
11	TW280 TDHB Roller Bottom		1
12	P0002698F	Roller Box 280x210	1
13	2982B	Parker Motor	1
14	P0002931M	Bottom Bearing Bush	1
15	P0001582F	Bracket Roller Box Guard Mount 156x232	1
16	TW 280 Top Slide Assembly		1
17	2116	Spring 387 Free Length	4
18	2888	Layflat 2 inches Spring	4
19	BO277	Set Screw M12 1.75 25 BZP	4
20	P0002678F	Stub Shaft Bottom	1
21	19259	Nordlock Washer M12	2
22	HY398	Washer Dowty 12	4
23	HY161	A adaptor Mm 3/8 - 3/8	4

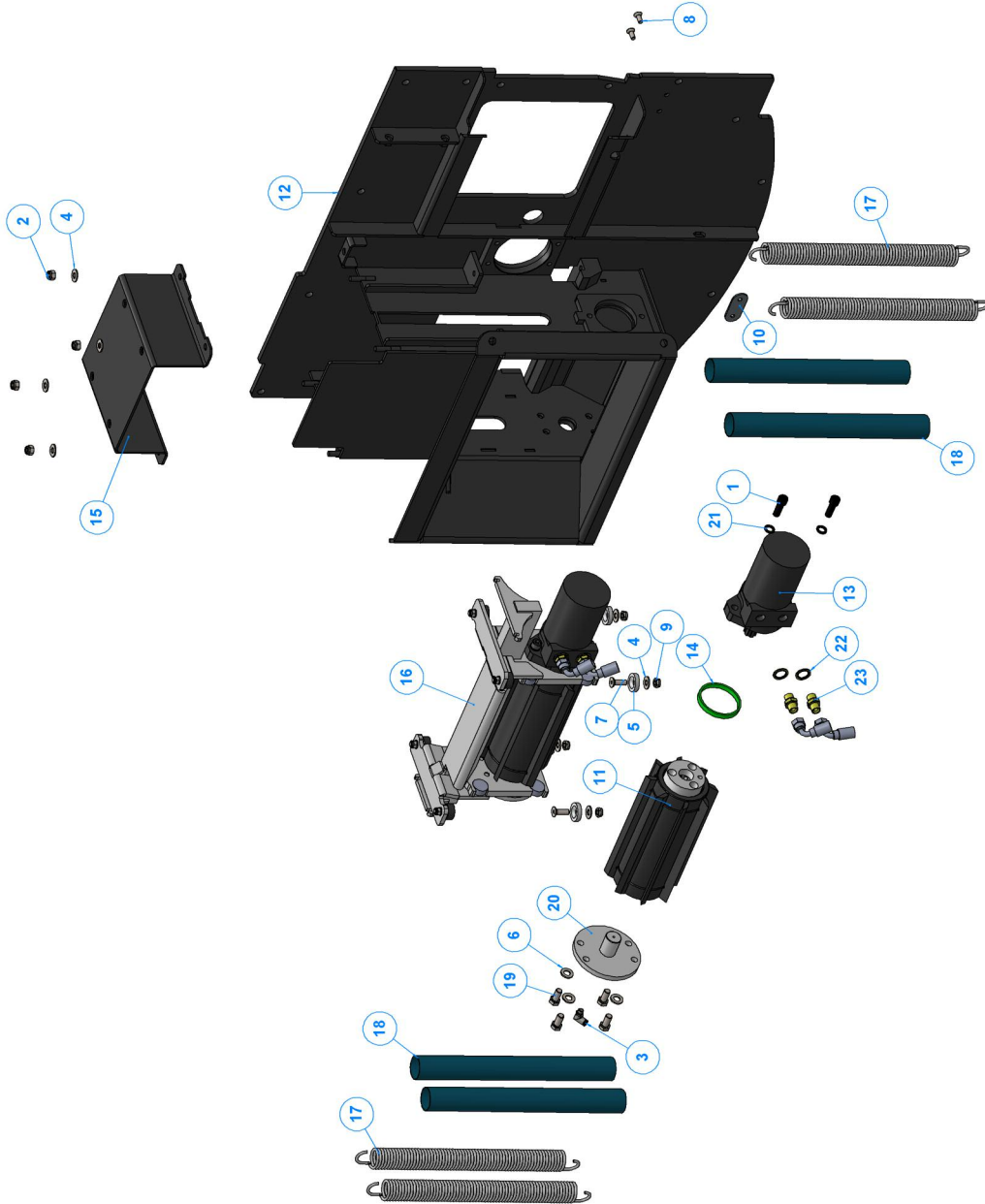

ROLLER BOX GUARDS



TIMBERWOLF
TW 280TDHB

52

ITEM NO.	PART NUMBER	DESCRIPTION	QTY.
1	2834	Av Mount VE Type	2
2	WA711	Washer M8 A BZP	8
3	P0001395	Bolt M12 1.75 150 BZP	1
4	NU644	Nut M12 P Nyloc	17
5	WA701	Washer M10 A BZP	4
6	BO360	Set Screw M10 25 BZP	4
7	BO321	Set Screw M12 30 BZP	1
8	NU045	Nut M12 1.75 Nyloc T	2
9	NU046	Nut M12 1.75 Plain BZP	2
10	18172	M12 X 45 Ht Set Z/P	2
11	NU479	Nut M8 1.25 Nyloc P	1
12	WA702	Washer M12 A BZP	17
13	BO878	Bolt M10 20 BZP	8
14	19259	Nordlock Washer M12	2
15	TW280 TDHB Roller Box		1
16	P0001650F	Bracket Spring Carrier OS	1
17	P0001773F	Guard Roller Box 824x279	1
18	P0001375	AV Mount M8 FF 30x30 60 (3030DD08-60)	2
19	TW280 TDHB Switch Mounting Roller Box		1
20	P0001080F	Bracket Access Hatch Switch	1
21	EL1348	Switch Limit (Metal Plunger)	1
22	BO856	Screw M5/20 Pan Pozi Bzp	2
23	18037	Set Screw M8 1.25 12 BZP	2
24	P0002644F	Bracket Spring Hanger	1
25	WA704	Washer M12 C BZP	4
26	BO429	Set Screw M12 35 BZP	2
27	WA839	Washer M10 C BZP	8
28	BO0346	Set Screw M8 1.25 20 BZP	2
29	P0002676M	Hardox Anvil Insert	1
30	P0002677M	Vertical Anvil	1
31	P0002914F	Access Hatch Assembly	1
32	P0001770F	Guard Roller Box Moving 255.5x329	1
33	BO350	Set Screw M8 25 BZP	1
34	P0002930F	Access Hatch Guard Stay	1
35	CO18-0714	M10 x 1.25 x 50 Fine Thread SKT Cap	1
36	P0002643	M12 1.75 90 Socket Cap Head	1

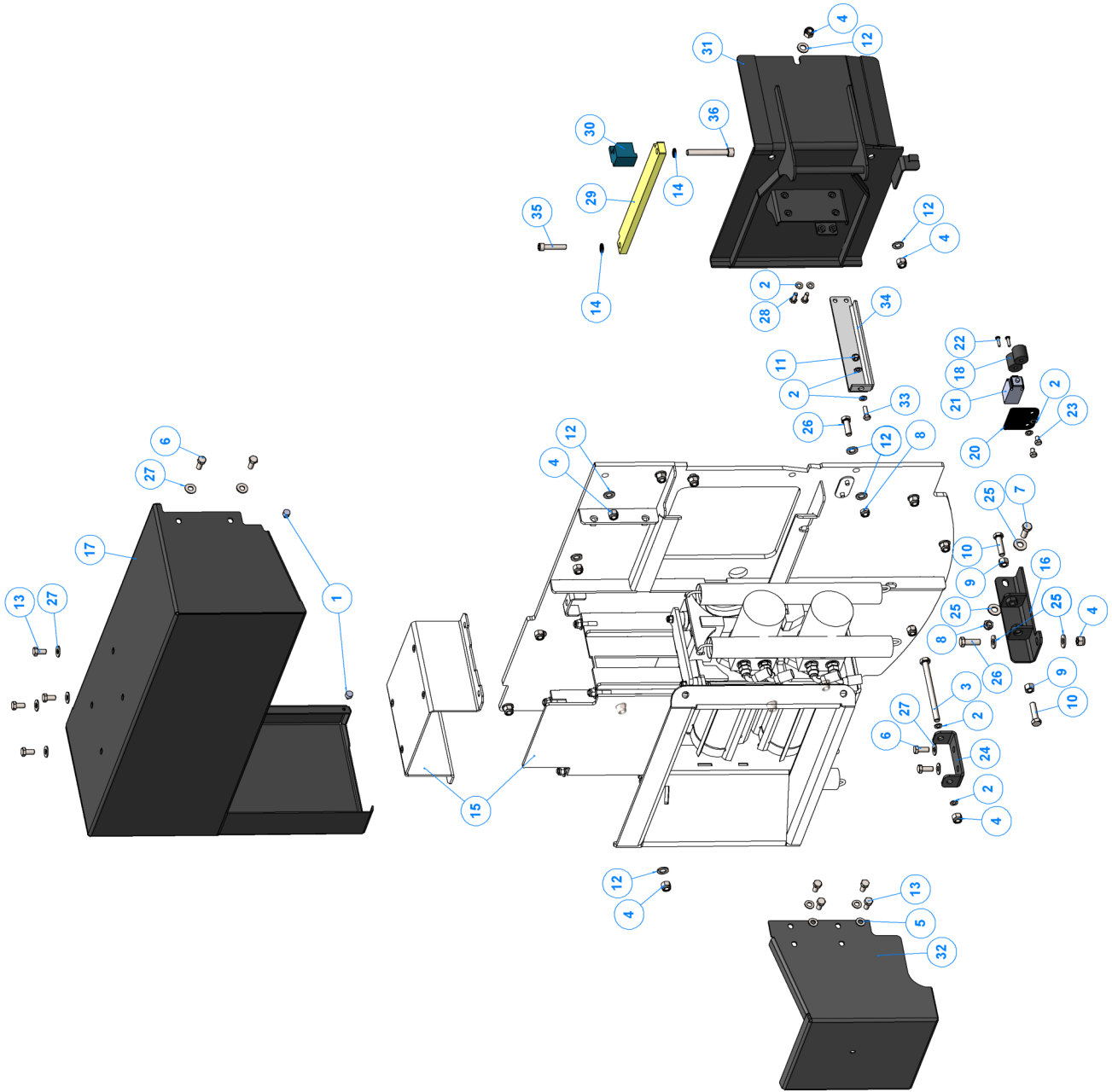



ITEM NO.	PART NUMBER	DESCRIPTION	QTY.
1	WA711	Washer M8 A BZP	4
2	NU479	Nut M8 1.25 Nyloc P	4
3	19259	Nordlock Washer M12	2
4	19730	Bolt M12 1.75 35 BZP	2
5	WA702	Washer M12 A BZP	4
6	BO277	Set Screw M12 1.75 25 BZP	4
7	BO386	Screw M10 1.5 30 Socket Cap	3
8	P0001401	Bolt Shear M10 1.5 55 BZP	3
9	P0002688F	Top Slide Roller Box 280 IS New	1
10	P0002623F	Roller Infeed Ø142 x 276 - 6 Blades	1
11	1361M	Bush Spline Top Roller Drive Ø74.9 - 29.5	1
12	2982B	Parker Motor	1
13	P0001327M	Bush Top Roller Ø76 - 30.5	1
14	P0002682F	Stub Shaft Top	1
15	3009	Slide Plug	8
16	18474	Fitting Grease Point Right Angle	1
17	P0002613	Male Cylindrical Buffer 3015VE20 70 Shore 30 x 15 - M8 x 20 Stud	4
18	HY396	Washer Dowty 38	2
19	HY161	Adaptor Mm 3/8 - 3/8	2
20	P0002932M	Spacer Top Roller Spline	1

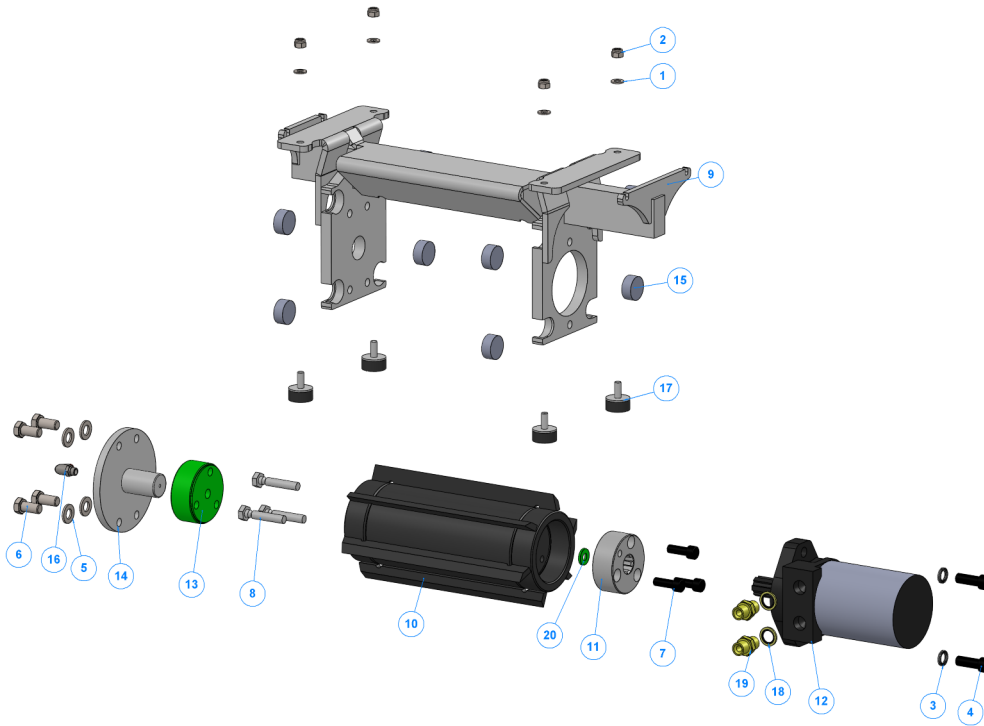

ITEM NO.	PART NUMBER	DESCRIPTION	QTY.
1	BO299	Socket Head Cap M10 1.5 40 BZP	3
2	P0001401	Bolt Shear M10 1.5 55 BZP	3
3	P0001327M	Bush Top Roller Ø76 - 30.5	1
4	P0001553F	Roller Infeed Ø142 x 276 - 8 Blades	1
5	4100M	Bush Spline Roller Drive	1

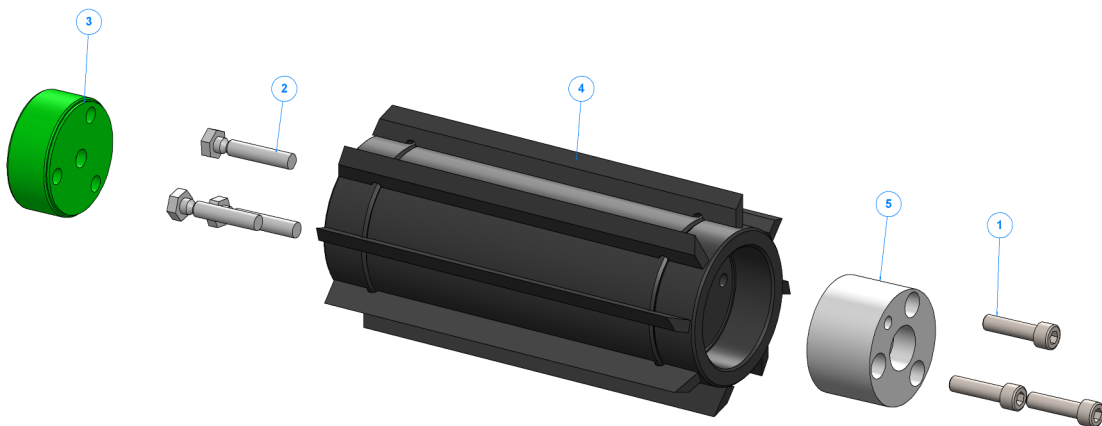



ITEM NO.	PART NUMBER	DESCRIPTION	QTY.
1	P0001659	Bearing 6309 C3	2
2	18474	Fitting Grease Point Right Angle	2
3	BO355	Csk Socket M8 16	2
4	WA1218	Washer M16 30 Hard.SLDPRT	4
5	NU1284	Nut M16 Nyloc T 1.50 Fine Bzp	4
6	BO1517	Bolt M12/40 Cap Screw	16
7	BO1527	Socket Head Cap M8 1.25 25	6
8	P0001879	Socket Head Cap M10 1.25 55	4
9	P0001778M	Shaft Rotor Ø750	1
10	P0001777M	Shaft Nose Rotor Ø750	1
11	P0001649M	Plate Blade Cutter 158 Length Bolt Anti Rotation 57 x 20mm	2
12	P0001776M	Blade Cutter 158 Length	2
13	18712M	Bolt M16 Blade	4
14	P0001780M	Housing Bearing 6309 Rear	1
15	P0001610	Seal 45 X 70 X 7	1
16	P0001779M	Cap Bearing 6309 Rear Ø65 ID	1
17	P0001781F	Paddle Rotor 152 Height	4
18	P0001543M	Housing Bearing 6309 Front	1
19	P0001544M	Bearing 6309 Cap Front External	1
20	P0001861	KM 9 Lock Nut (Lock Washer Type) M45 x 1.5mm	1
21	P0002393	Shim Shaft ID45	1
22	P0003644	Shim Shaft 280 - 1mm	1
23	P0001546M	Rotor Disc Ø750	1

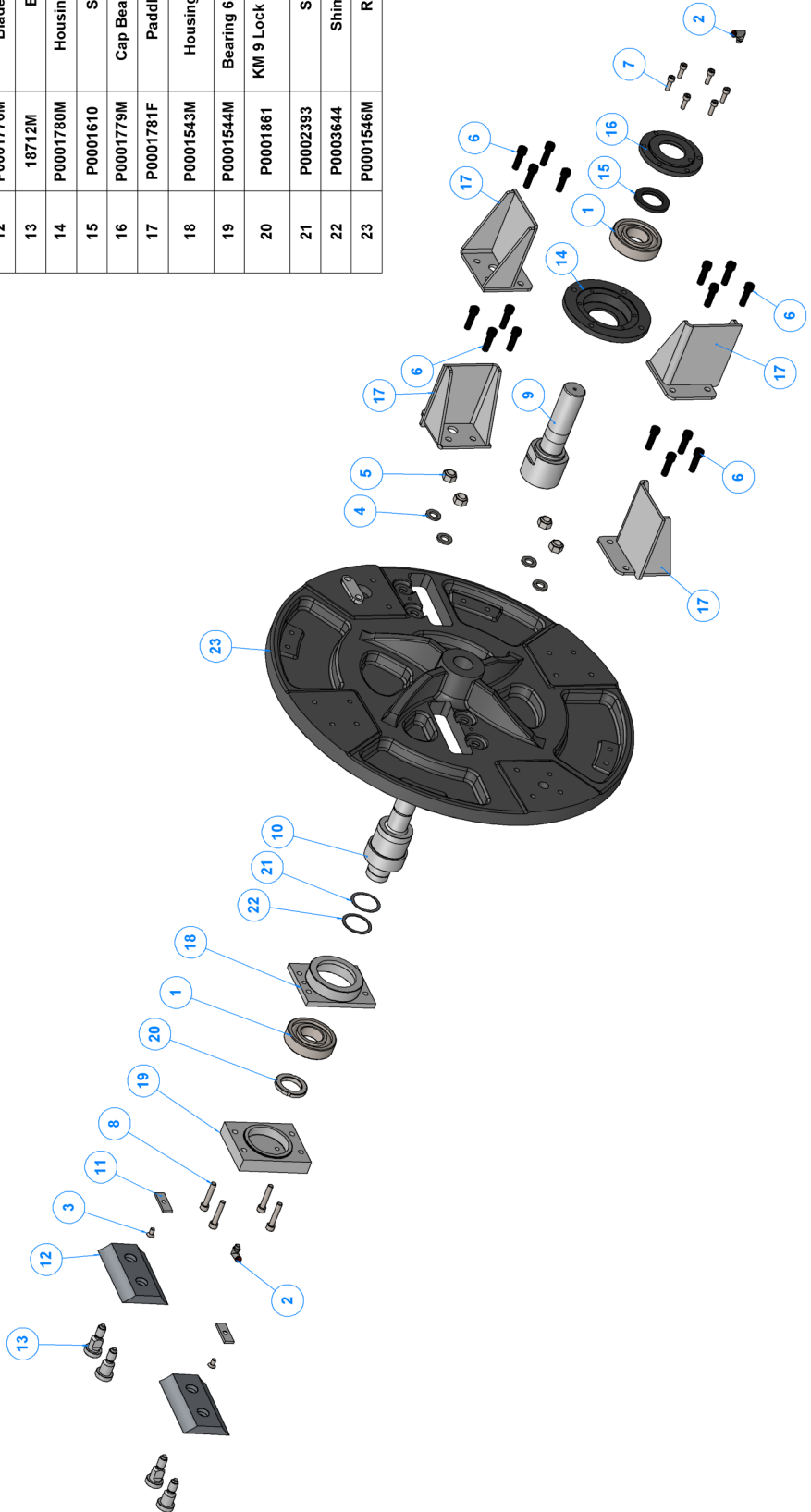



ITEM NO.	PART NUMBER	DESCRIPTION	QTY.
1	WA704	Washer M12 C BZP	4
2	BO321	Set Screw M12 30 BZP	8
3	BO438	Pan Head Pozi M6 1.0 16 BZP	2
4	WA702	Washer M12 A BZP	4
5	WA711	Washer M8 A BZP	4
6	BO0346	Set Screw M8 1.25 20 BZP	4
7	WA709	Washer M6 C BZP	2
8	TW280 TDHB Rotor Disc		1
9	P0001721F	Rotor Housing Ø750 - 221	1
10	TW280 TDHB Grease Point	Grease Point 128.5x49x3 Assy	1
11	P0001737	Profile 128.5x49x3 Grease Point	1
12	C072-0101	45° Grease Nipple 1-8" BSP Kit	4
13	TW280 TDHB Belt Tensioner		1
14	TW280 TDHB Control Panel with 12V Outlet	Control Panel Assy. With 12 Volt Outlet	1
15	P0002316F	Bracket Rotor Housing Electrical Panel Assy	1

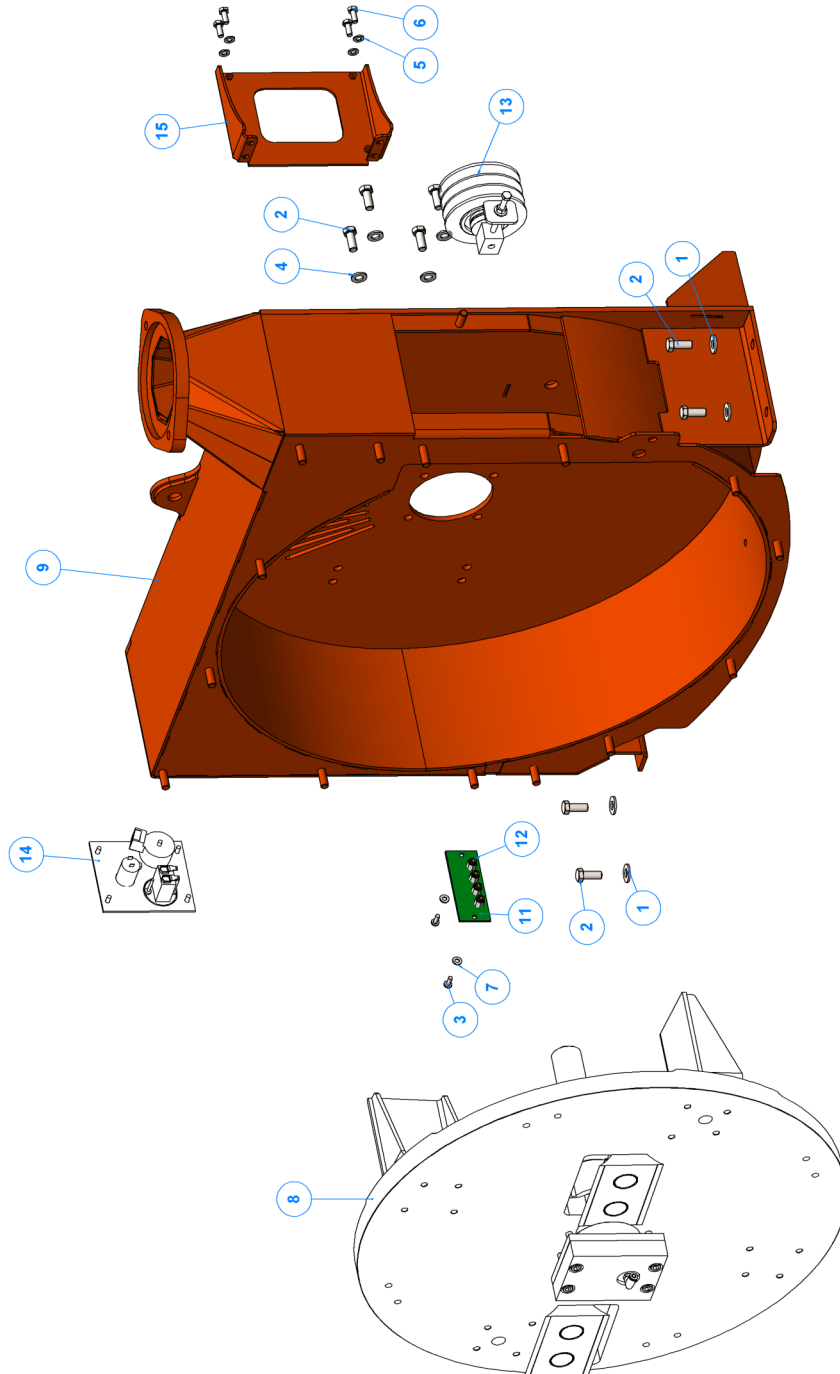

WARRANTY SERVICE CHECK RECORD



TIMBERWOLF
TW 280TDHB

56

Model number:		Serial number:	
Date of delivery/ handover:		Options/extras:	
Dealer pre delivery check:			
Inspected by:			

50 HOUR WARRANTY SERVICE CHECK

Date:	
Hours:	
Invoice number:	
Signature:	
Next service due:	

Authorised dealer stamp

11 MONTH WARRANTY SERVICE

Date:	
Hours:	
Invoice number:	
Signature:	
Next service due:	

Authorised dealer stamp

23 MONTH WARRANTY SERVICE

Date:	
Hours:	
Invoice number:	
Signature:	
Next service due:	

Authorised dealer stamp



Date:

Hours:

Invoice number:

Signature:

Next service due:

Authorised dealer stamp

Date:

Hours:

Invoice number:

Signature:

Next service due:

Authorised dealer stamp

Date:

Hours:

Invoice number:

Signature:

Next service due:

Authorised dealer stamp

Date:

Hours:

Invoice number:

Signature:

Next service due:

Authorised dealer stamp



Timberwolf Wood Chippers & Shredders

Tomo Industrial Estate, Stowmarket, Suffolk IP14 5AY, United Kingdom

T: +44 1449 765809 E: info@timberwolf-uk.com W: timberwolf-uk.com



timberwolf-uk.com